

Polished brass finish

**A Traditional pull handle**

- For face fixing
- Fixing screws included
- Brass

Finish	Cat. No.
Satin nickel plated	970.30.716
Polished chrome plated	970.30.712
Polished brass	970.30.718

Order qty: 1 pc

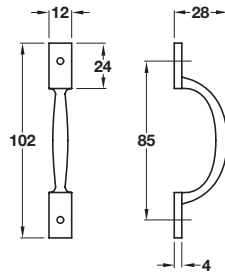

Polished brass finish

**B Traditional pull handle**

- For face fixing
- Fixing screws included
- Brass

Finish	Cat. No.
Satin nickel plated	970.30.726
Polished chrome plated	970.30.722
Polished brass	970.30.728

Order qty: 1 pc

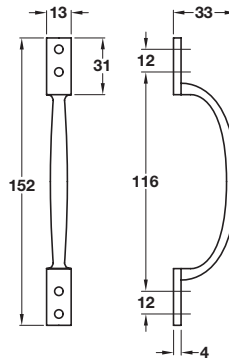

Polished brass finish

**C Pole hook**

- To suit Ø 25 mm pole (pole not supplied)
- Fixing screws included
- Brass

Finish	Cat. No.
Polished brass	979.00.608

Order qty: 1 pc

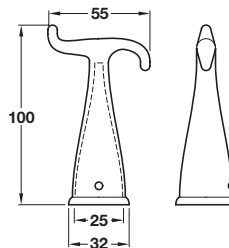

Satin nickel finish

**D Pole holder**

- To suit pole hook, item C
- Fixing screws included
- Brass

Finish	Cat. No.
Satin nickel plated	979.00.616
Polished chrome plated	979.00.612
Polished brass	979.00.618

Order qty: 1 pc

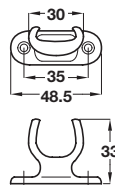

Satin nickel finish

**E Sash stop**

- Fixings included
- Order key separately, see item F
- Brass

Finish	Cat. No.
Satin nickel plated	970.03.356
Polished chrome plated	970.03.352
Polished brass	970.03.358

Order qty: 1 pc

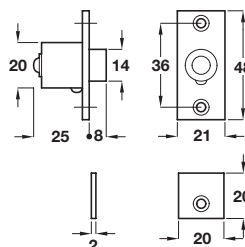

**F Sash stop key**

- To suit item E
- 125 mm long key, one key suits all
- Nickel plated brass

Cat. No.	970.03.360
----------	------------

Order qty: 1 pc

