

Overhead Door Closers TS 1200 and TS 1000

BS EN 1154



A TS 1200 overhead rack and pinion door closer

- Specification:**
Surface mounted rack and pinion door closer with flat form arm for doors up to 1100 mm with variable closing force and latching action
- Features:**
Rack and pinion
Flat form arm
Closing force by power shoe (size EN 2-3)
Adjustable closing speed and latching action
- Models**
Fig 1, Fig 61 and Fig 66
- Options** (see page 24 for details)
Hold open arm (not for fire doors)
- Certification**
Tested and approved to BS EN 1154: 1997
Tested to conform with CE requirements
Certifire approved; certificate no. CF144
120 mins timber
- Material:**
Aluminium body. Mild steel arm
ABS cover
- A door stop should always be used for non backchecked doors, and where practical for backchecked doors, and at least 66% of the door width away from the hinge

TS 1200: Fig 1/61/66

Finish	Cat. No.
Silver	931.17.039
Simulated satin stainless steel	931.17.030
Simulated pol. stainless steel	931.17.031

Order qty: 1 pc

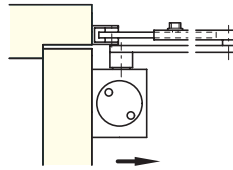

Fig 1 Standard application
Closer is fixed to the pull side of the door

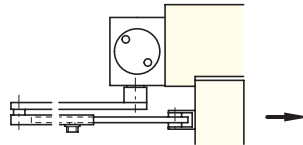

Fig 61 Transom application
Closer is fixed to the push side of the door (overhead installation)

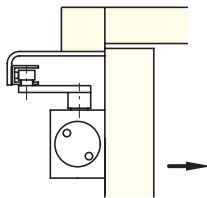
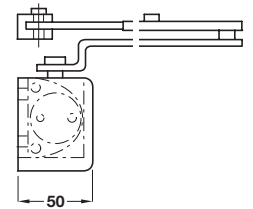
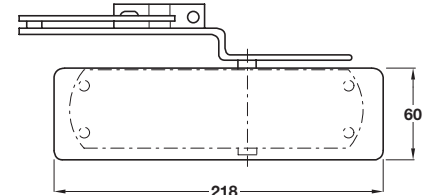

Fig 66 Parallel arm application
Closer is fixed to the push side of the door using fixing bracket



Simulated satin stainless steel finish



Closing force

Size	Max. door width	Min. closing moments
2	850 mm	13 Nm
3	950 mm	18 Nm

BS EN 1154



B TS 1000 overhead rack and pinion door closer

- Specification:**
Surface mounted rack and pinion door closer with flat form arm for doors up to 1100 mm with adjustable closing force and latching action
- Features:**
Rack and pinion
Flat form arm
Closing force by power shoe (size EN 2-3)
Adjustable closing speed and latching action
- Models**
Fig 1, Fig 61 and Fig 66 (Fig 66 with parallel arm bracket which must be ordered separately)
- Options** (see page 24 for details)
Hold open arm (not for fire doors)
Parallel arm bracket (see page 24/A; 931.16.459)
- Certification**
Tested and approved to BS EN 1154: 1997
Tested to conform with CE requirements
Certifire approved; certificate no. CF144
120 mins timber
- Material:**
Aluminium body. Mild steel arm
- A door stop should always be used for non back checked doors, and where practical for back checked doors, and at least 66% of the door width away from the hinge

TS 100: Fig 1/61

Finish	Cat. No.
Silver	940.18.109
Gold	940.18.108

Order qty: 1 pc

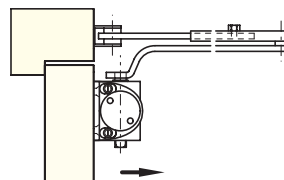

Fig 1 Standard application
Closer is fixed to the pull side of the door

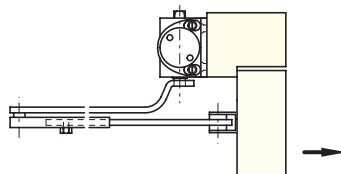
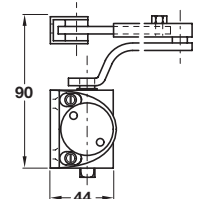
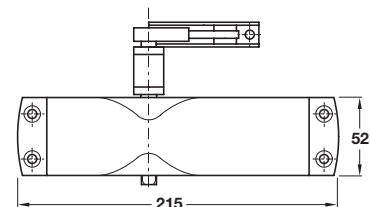

Fig 61 Transom application
Closer is fixed to the push side of the door (overhead installation)



Silver colour finish



Closing force

Size	Max. door width	Min. closing moments
2	850 mm	13 Nm
3	950 mm	18 Nm