

BS EN 1154

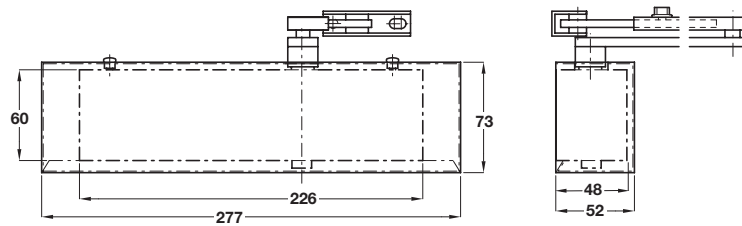

Satin stainless steel finish



## A TS 2000 NVBC overhead rack and pinion door closer, designer cover

### • Specification:

Surface mounted rack and pinion door closer with flat form arm for doors up to 1250 mm with variable closing force, backcheck and hydraulic latching action  
All adjustments on the front of closer

### • Features:

Rack and pinion  
Flat form arm  
Closing force variable (size range EN 2-4)  
Backcheck with latching action by valve  
Valve adjusting closing speed

### • Models

Standard (Fig 1, Fig 61, Fig 66)

### • Options (see page 24-27 for details)

Hold open arm (not for fire doors)  
Arch door drop plate  
Fig 1 architrave bracket  
Overpanel bracket  
Mounting plate  
Soffit bracket, frame mounting  
Fig 1 glass clamping plate

### • Certification

Tested and approved to BS EN 1154: 1997  
Tested to conform with CE requirements  
Certifire approved; certificate no. CF252  
120 mins timber

### • Material:

Aluminium body. Mild steel arm  
Stainless steel cover  
Also available: Electro-mechanical hold-open version (see page 49)  
A door stop should always be used for non back checked doors, and where practical for back checked doors, and at least 66% of the door width away from the hinge

### TS 2000 NVBC: Fig 1/61/66

Finish	Cat. No.
Satin stainless steel	931.16.180
Polished stainless steel	931.16.181

Order qty: 1 pc

### Closing force

Size	Max. door width	Min. closing moments
2	850 mm	13 Nm
3	950 mm	18 Nm
4	1100 mm	26 Nm

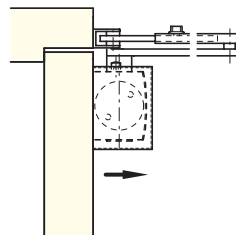

**Fig 1 Standard application**  
Closer is fixed to the pull side of the door

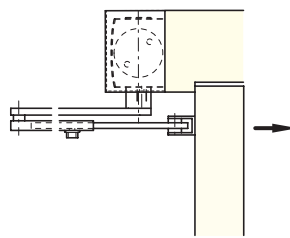

**Fig 61 Transom application**  
Closer is fixed to the push side of the door (overhead installation)

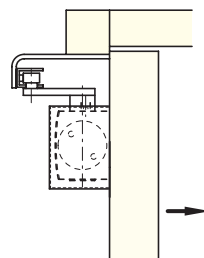

**Fig 66 Parallel arm application**  
Closer is fixed to the push side of the door using fixing bracket