

Matt nickel finish

A Flush pull handle

- Ø 50 x 12 mm
- Suitable for timber cabinet/wardrobe doors
- Press-in fixing
- Zinc alloy

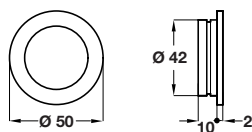

Finish	Cat. No.
Matt nickel	153.20.630
Polished brass	153.20.830
Polished chrome	153.20.230

Order qty: 1 pc

Polished chrome finish

B Flush pull handle

- 50 x 50 mm
- Suitable for timber cabinet/wardrobe doors
- Push fixing
- Zinc alloy

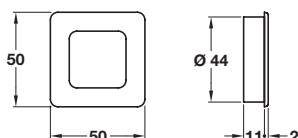

Finish	Cat. No.
Polished chrome	151.94.202
Aluminium coloured	151.94.402
Matt nickel	151.94.602

Order qty: 1 pc

Polished nickel rim, matt inside finish

C Flush pull handle

- Ø 55 x 11 mm
- Suitable for timber cabinet/wardrobe doors
- Pin fixing
- Fixings not included
- Steel

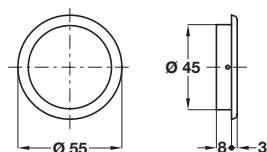

Finish	Cat. No.
Polished nickel plated, matt inside	153.20.733
Polished gold coloured	153.20.531

Order qty: 1 pc



D Flush pull handle

- 100 x 52 x 17 mm
- Suitable for timber sliding doors
- Concealed screw fixing
- Fixings not included
- Nylon
- Note: Other colours available to order, subject to quantity

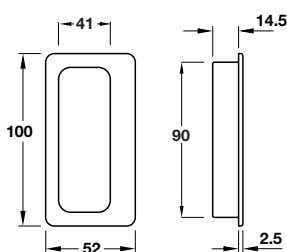

Red finish



Finish	Cat. No.
Red	908.04.412
Black	908.04.416
Dark grey	908.04.418
White	908.04.419
Dark blue	908.04.437
Yellow	908.04.422

Order qty: 1 pc



TCH-A1 2008, HUK. Dimensional data not binding. We reserve the right to alter specifications without notice.