

A Door holder, magnetic

- Concealed fixing
- Release force 120N
- Spring loaded magnet
- Black plastic height pad included

Will hold doors up to:
Weight - 60 kg
Height - 2200 mm
Width - 1000 mm

- Fixings included
- Stainless steel or aluminium
- For matching door stop, see page 62

Item A.
Text added

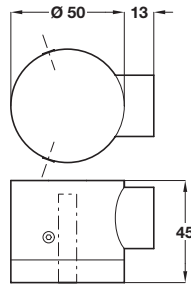

Silver anodised aluminium finish

K W S



Finish	Cat. No.
Satin stainless steel	938.02.300
Silver anodised	938.02.301

Order qty: 1 pc

B Door holder and stop, locking

- Mounted in floor
- Depress stop to hold door open or close door
- To make inoperable, depress and turn
- Fixings included
- Grade 316 stainless steel, black rubber stop

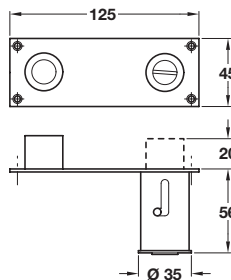

Satin stainless steel finish



Finish	Cat. No.
Satin stainless steel	938.26.000

Order qty: 1 pc

C Door holder and stop, locking

- Mounted in floor
- Depress stop to hold door open or close door
- To make inoperable, depress and turn
- Fixings included
- Grade 316 stainless steel, black rubber stop

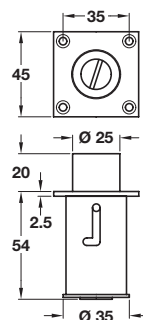

Satin stainless steel finish



Finish	Cat. No.
Satin stainless steel	938.09.001

Order qty: 1 pc

Lockable operation

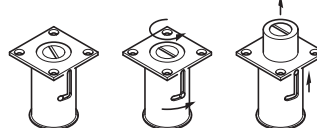

D Door holder and stop, non-locking

- Mounted in floor
- Depress stop to hold door open or close door
- Fixings included
- Stainless steel, grade 316, black rubber stop

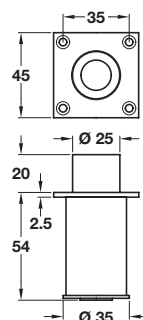

Satin stainless steel finish



Finish	Cat. No.
Satin stainless steel	938.09.000

Order qty: 1 pc

08.07.10/1*