



A Round bell push, brass

- Concealed fixing, fixings included
- Stainless steel/hot-stamped forged brass
- Polished brass finish with PVD Zirconium coating

Cat. No.	986.10.005
----------	------------

Order qty: 1 pc

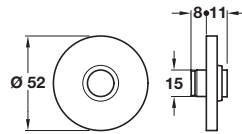

B Oval bell push, brass

- Concealed fixing, fixings included
- Stainless steel/hot-stamped forged brass
- Polished brass finish with PVD Zirconium coating

Cat. No.	986.10.015
----------	------------

Order qty: 1 pc

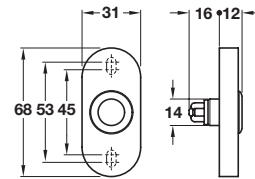

C Round bell push, stainless steel

- Concealed fixing, fixings included
- Stainless steel or brass

Finish	Cat. No.
Polished stainless steel	986.10.001
Satin stainless steel	986.10.000
Polished brass	986.10.005

Order qty: 1 pc

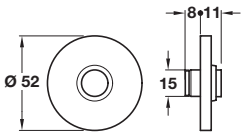

Item C.
Illustration and photo amended



D Architrave bell push, brass

- Fixing screws included
- Brass

Finish	Cat. No.
Polished brass	986.07.308
Satin chrome	986.07.304
Polished chrome	986.07.302

Order qty: 1 pc

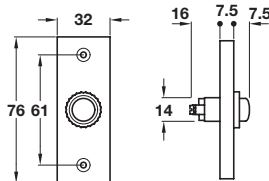

Item D.
Illustration and photo amended



E Square bell push, brass

- Fixing screws included
- Brass

Finish	Cat. No.
Polished brass	986.07.318
Satin chrome	986.07.314
Polished chrome	986.07.312

Order qty: 1 pc

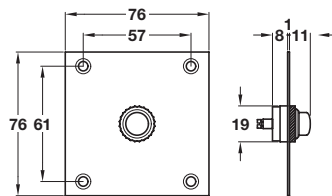

Kirkpatrick Ltd.

F Rectangular bell push, malleable iron

- Fixing screws included
- Malleable iron

Finish	Cat. No.
Black powder coated	986.07.633
Pewter powder coated	986.07.639

Order qty: 1 pc

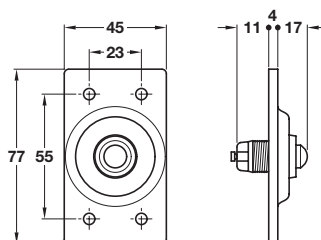

Note: Due to the manufacturing process, the dimensions given may vary.

