

## A Ball end cap

- Suitable for Ø 38 mm tube
- Slots over end of tube
- Secured with grub screws included
- Stainless steel or brass

Finish	Cat. No.
Satin stainless steel	812.56.080
Polished stainless steel	812.56.180
Polished brass	812.56.880
Polished chrome	812.56.280

Order qty: 1 pc

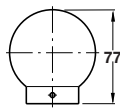

Polished chrome finish



## B Ball end cap

- Suitable for Ø 51 mm tube
- Slots over end of tube
- Secured with grub screws included
- Stainless steel or brass

Finish	Cat. No.
Satin stainless steel	812.66.080
Polished stainless steel	812.66.180
Polished brass	812.66.880
Polished chrome	812.66.280

Order qty: 1 pc

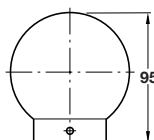

Polished chrome finish



## C Railing support tube set

- For use with Ø 38 mm tube, to create a balustrade
- Includes support tube, cover plate and mounting plate
- Rail secured with grub screws included
- **Fixing screws for mounting plate are not included**
- Brass and mild steel

Finish	Cat. No.
Polished brass	812.52.805
Polished chrome	812.52.205

Order qty: 1 set

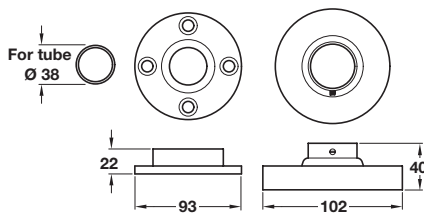

Polished brass finish



## D Railing support tube set

- For use with Ø 51 mm tube, to create a balustrade
- Includes support tube, cover plate and mounting plate
- Rail secured with grub screws included
- **Fixing screws for mounting plate are not included**
- Brass and mild steel

Finish	Cat. No.
Polished brass	812.62.805
Polished chrome	812.62.205

Order qty: 1 set

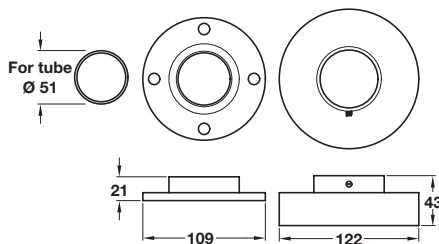

Polished chrome finish



## E Straight railing tube, Ø 25 mm

- 5 m lengths
- Stainless steel

Finish	Cat. No.
Satin stainless steel	812.70.006
Polished stainless steel	812.70.106

Order qty: 1 pc



Polished stainless steel finish



## F Wall flange socket

- Suitable for Ø 25 mm tube
- For wall mounting of stainless steel tube
- Rail secured with grub screws included
- **Wall mounting fixing screws are not included**
- Stainless steel

Finish	Cat. No.
Satin stainless steel	812.72.000
Polished stainless steel	812.72.100

Order qty: 1 pc

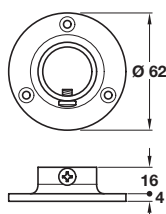

Polished stainless steel finish

