

# Brass Butt Hinges Washed

Regular lubrication required, unless marked 'maintenance free'.

**Important:** The logo shown indicates the type and size of screw required, which must be ordered separately



## A Brass DPBW butt hinge

- Maximum adjusted door weight **60 kg**
- Double phosphor bronze washers and brass pin
- 11 mm Ø knuckle
- Fixing screws are not included and must be ordered separately
- Brass

<b>Length x width</b>	<b>100 x 75 mm</b>	
Finish		
Polished brass	926.90.118	

Order qty: 1 pc

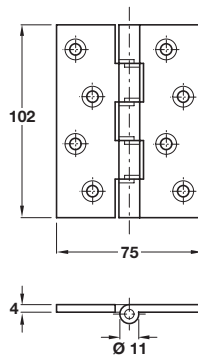

## B Brass DPBW butt hinge

- Maximum adjusted door weight **55/60 kg**
- Double phosphor bronze washers and brass pin
- 11 mm Ø knuckle
- Fixing screws are not included and must be ordered separately
- Brass

<b>Length x width</b>	<b>100 x 66 mm</b>	
Flap thickness	3 mm	4 mm
Max. door weight	<b>55 kg</b>	<b>60 kg</b>
Self colour	926.90.060	-
Polished brass	-	926.90.068
Polished chrome	-	926.90.062

Order qty: 1 pc

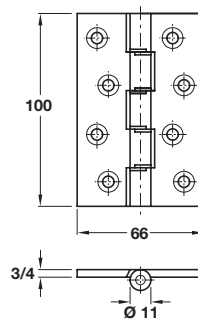

Polished chrome finish shown

## C Brass DPBW butt hinge

- Maximum adjusted door weight **40 kg** @ 25,000 cycles
- Double phosphor bronze washers and brass pin
- 12 mm Ø knuckle
- Fixing screws are not included and must be ordered separately
- Brass

<b>Length x width</b>	<b>100 x 76 mm</b>	
Finish		
Polished brass	921.17.068	

Order qty: 1 pc

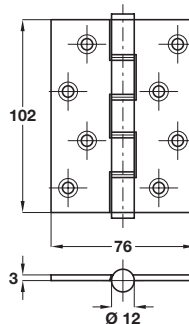

## D Brass DSW butt hinge

- Maximum adjusted door weight **20 kg**
- Double steel washers and brass pin
- 8 mm Ø knuckle
- Fixing screws are not included and must be ordered separately
- Brass

<b>Length x width</b>	<b>102 x 67 mm</b>	
Finish		
Self colour	926.85.000	

Order qty: 1 pc

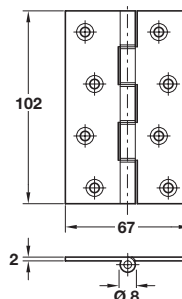

## Hinge wood screws

Hospa chipboard screws countersunk head, Ø 5.0 x 30 mm with cross-slots. Brass.



Finish	Cat. No.
Self colour	014.32.041
Polished brass	014.32.841
Polished chrome	014.32.241
Satin chrome	014.32.441
Bronze	014.32.141

Order qty: Multiples of 200 pcs