

2



A Modular mortice 5 lever clawbolt deadlock

- For sliding doors
- **Operation:** Clawbolt operated by key
- **Case:** Modular epoxy polyester powder coated steel, 14 mm wide
- **Forend:** Square, 2 piece. Stainless steel or brass
- **Strike plate:** Square, flat. Included. Stainless steel or brass
- **Clawbolt:** Brass, 16 mm throw
- **Escutcheons:** 2 plain escutcheons included
- **Differs:** 200 differs
- **Keys:** 2 keys included
- To differ only
- 57 mm backset
- Fixing screws included

Finish	Cat. No.
Satin stainless steel	911.26.157
Satin brass	911.26.158

Order qty: 1 pc

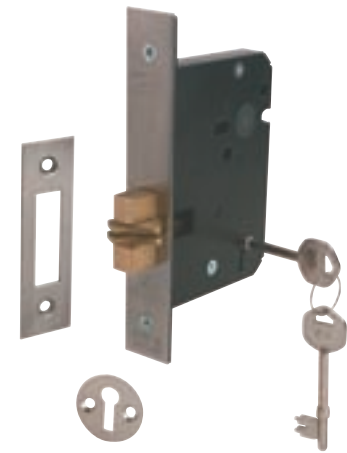
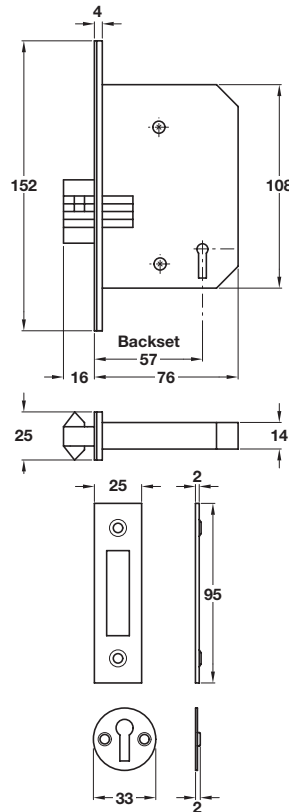

B Modular mortice 5 lever escape deadlock

- **Operation:** Deadbolt operated by key from both sides. Emergency or rapid exit by inside lever handle
- **Case:** Modular epoxy polyester powder coated steel, 14 mm wide
- **Forend:** Square, 2 piece. Stainless steel or brass
- **Strike plate:** Square, flat. Included. Stainless steel or brass
- **Deadbolt:** Brass with hardened steel rollers. 13 mm throw
- **Differs:** 200 differs
- **Keys:** 2 keys included
- To differ only
- **Escutcheons:** 2 plain escutcheons included
- 57 mm backset
- Fixing screws included

Finish	Cat. No.
Satin stainless steel	911.22.346
Satin brass	911.22.347

Order qty: 1 pc

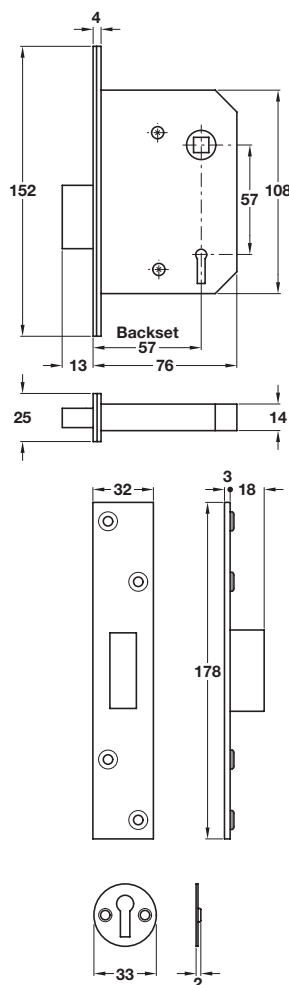

TCH-A1 2008, HUK. Dimensional data not binding. We reserve the right to alter specifications without notice.