

Order Euro profile cylinders separately, shown in Section 2 pages 45-50



Use counter case with lock for locking two bi-parting sliding doors or a single door closing against an adjacent flush fixed panel



Use wall profile, seal and strike plate with lock, for locking to jamb or wall: single sliding door applications

### A Lock

For 17 mm Euro profile cylinder. Unhanded. Use in conjunction with counter case, wall profile or lock bracket. Steel. **Order cover plates B separately**

Cat. No.	941.24.020
----------	------------

Order qty: 1 pc

### B Cover plates for lock

Plastic

Finish	Cat. No.
Unfinished	941.24.120
Polished chrome	941.24.122
Matt chrome	941.24.124
Polished brass	941.24.128
Stainless steel effect	941.24.129

Order qty: 1 pair

### C Counter case

Including centering assemblies. Unhanded. Steel

**Order cover plate D separately**

Cat. No.	941.24.030
----------	------------

Order qty: 1 pc

### D Cover plate for counter case

Plastic

Finish	Cat. No.
Unfinished	941.24.130
Polished chrome	941.24.132
Matt chrome	941.24.134
Polished brass	941.24.138
Stainless steel effect	941.24.139

Order qty: 1 pc

### E Wall profile

Undrilled. Anodised aluminium

Length	Cat. No.
2.5 m	941.24.925
3.5 m	941.24.935

Order qty: 1 pc

### F Rubber seal

For use with wall profile E. Black rubber

Length	Cat. No.
2.5 m	941.24.081
3.5 m	941.24.082

Order qty: 1 pc

### G Strike plate

For use with wall profile E. With centering element. Anodised aluminium

Cat. No.	941.24.040
----------	------------

Order qty: 1 pc

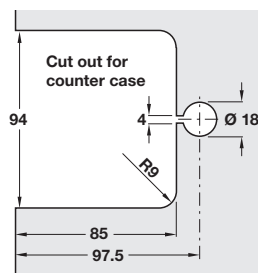
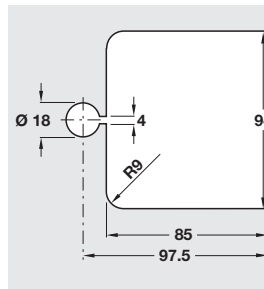

Cut out for lock and counter case are the same

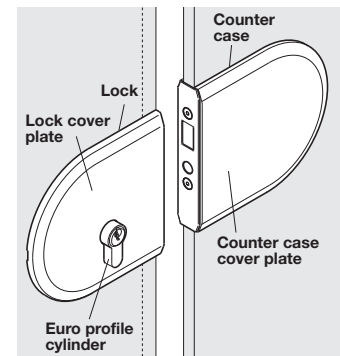
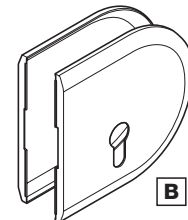
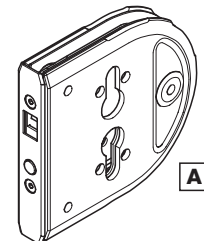
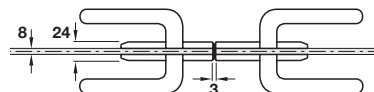
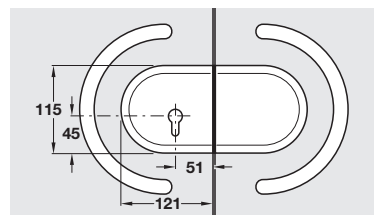
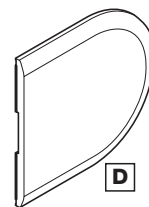
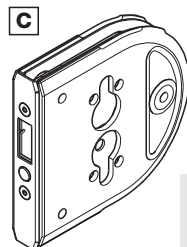

Order separately

