

- **Application:** For internal or external doors. Ideal for commercial usage. For heavy straight sliding bottom rolling doors and windows. Single or multiple runs of track. Ideal for sliding double glazed doors
- **Range:**
Max. door weight **400 kg**
Max. door height **3.5 m**
Consider wind pressure on external doors
- **Recommended door construction:**
Door thickness **±60 mm** according to type of construction. Bottom rail should be sufficiently deep to house roller casing
- **Fixing:** Top guide tracks soffit fixed. Floor tracks may be recessed. Mortise for bottom rollers must fit tight around casing, so that weight of door is carried on top of roller casing above wheel
- For **Series 880** parallel top track brackets, please see page **76**
- For **ancillary door fittings, locks, handles, bolts, etc.** see pages **5-22**

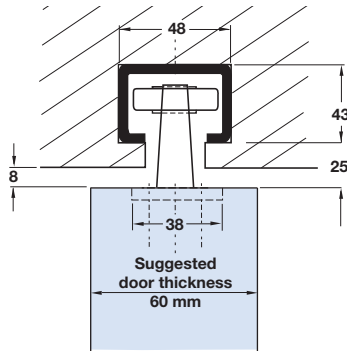
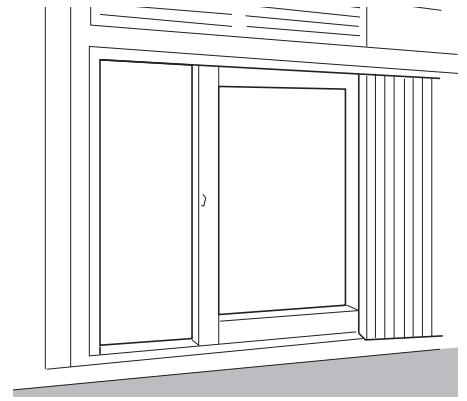

A Top safety guide channel

Undrilled. Galvanized steel to BS EN 10142

Length	Cat. No.
2.4 m	942.53.824
3.0 m	942.53.830

Order qty: 1 pc (2.4 or 3.0 m length)

B Top guide

Offset twin wheels, rattle proof. Neoprene wheels with aluminium frame

Cat. No.	942.53.030
----------	------------

Order qty: 1 pair (1 pair required per panel)

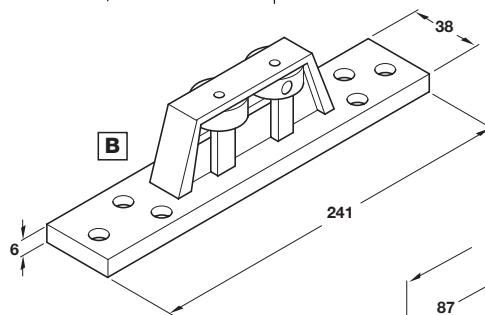

C Soffit fixing bracket, open

For parallel and cross ear applications.

Important: Use universal soffit fixing brackets to suit channel **A**, where door panels are extra large or exposed to severe wind pressure. These brackets give additional support to the top guide channel. Galvanized pressed steel

Cat. No.	942.53.080
----------	------------

Order qty: 1 pc (500 mm fixing centres)

D Closed end piece

To convert **C** to closed end bracket, unhandled. Galvanized pressed steel

Cat. No.	941.80.082
----------	------------

Order qty: 1 pair

E Soffit fixing bracket, lock-joint type

To couple separate channel lengths. Galvanized pressed steel

Cat. No.	942.53.082
----------	------------

Order qty: 1 pc

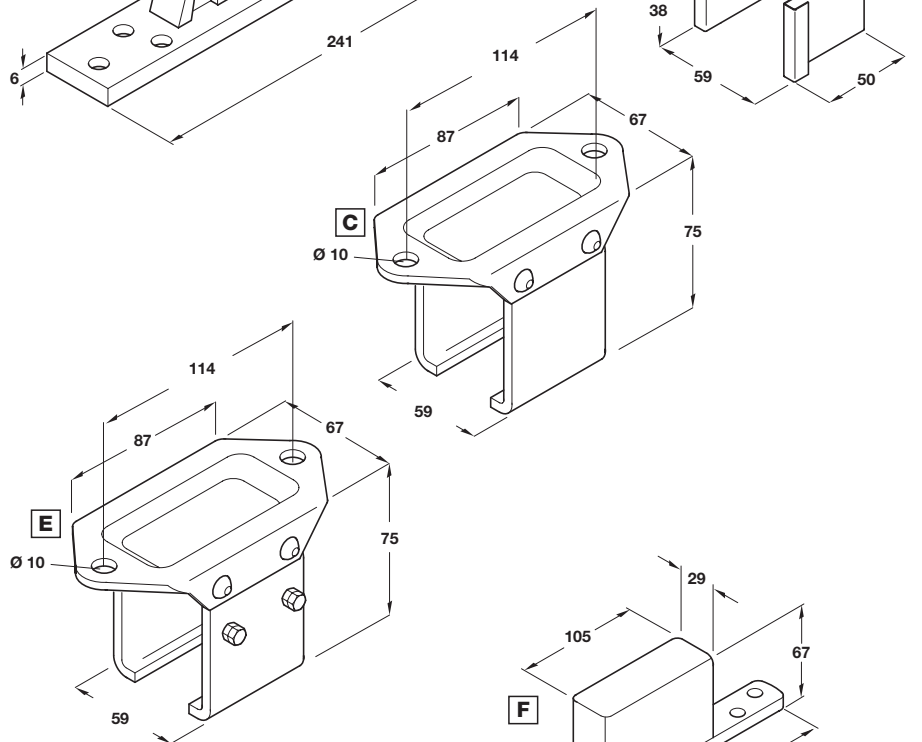

F Bottom roller

Die cast casing. Steel wheel with ball bearing

Cat. No.	942.53.010
----------	------------

Order qty: 1 pair (1 pair required per panel)

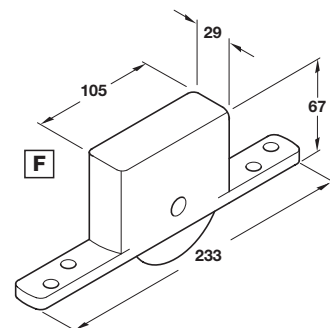
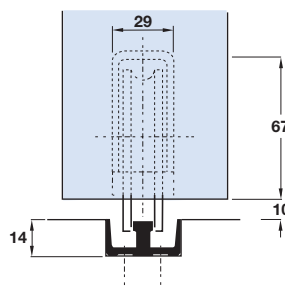

G Bottom track, 14 x 30 mm

Pre-drilled for countersunk screws. Brass

Length	Cat. No.
1.8 m	942.53.918
3.0 m	942.53.930

Order qty: 1 pc (1.8 or 3.0 m length)

