

- Application:** High performance, vertically adjustable sliding door fitting, soffit fixing, for timber door weights up to **160 kg**. Exceptionally light and silent action. All parts are corrosion resistant
- Range.**
 - Max. door weight **160 kg**
 - Min. door thickness **35 mm**
 - Max. door height normally **2.5 m**
- Tracks are not supplied with the fitting set and must be ordered separately**
- Installation drawing reference **17689**

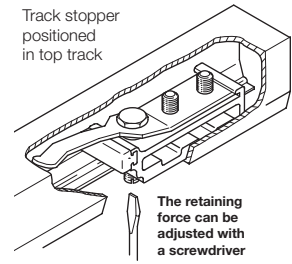
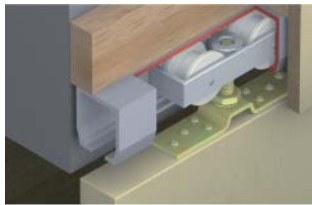

For ancillary door fittings, locks, handles, bolts, seals, etc. see pages 4-6

Item A.
2.0 m version 941.60.200 added

A Junior 160 top track

With screw holes for soffit fixing. Silver anodised aluminium. **Two top tracks are mounted side by side for double or multiple doors**

Length	2.0 m	3.0 m
Cat. No.	941.60.200	941.60.300

Order qty: 1 pc (2.0 or 3.0 m length)

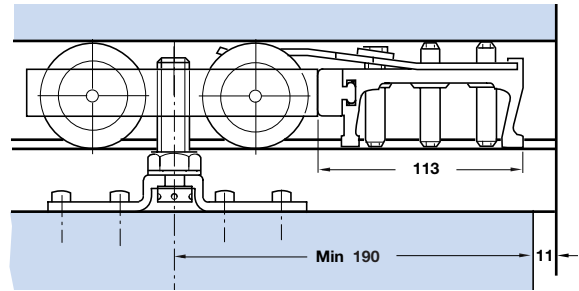
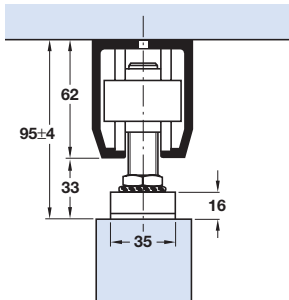

HAWA-Junior 160 fitting set

B Trolley hanger. Sleeve bearing mounted, high-grade polyamide tandem rollers. Aluminium carriage and galvanized steel mounting plate

C Track stopper. For adjustable mounting in top track. Zinc alloy housing with steel spring and rubber buffer. Adjustable retaining force

D Guide, rattle proof. For screw mounting to floor black plastic

E Rubber buffer. Screw fixing

For 1 door	
B Trolley hanger	2 pcs
C Track stopper	1 pc
D Guide	1 pc
E Rubber buffer	1 pc
Cat. No.	941.60.001

Order qty: 1 set

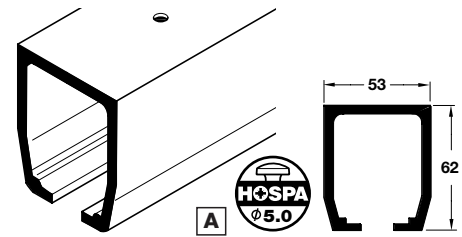
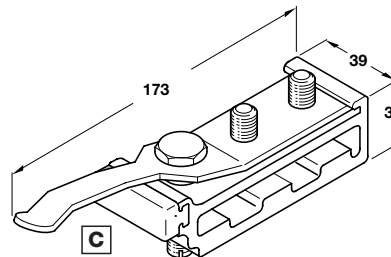

Important mounting note: If the sliding door is required to stop at both ends, we recommend installing an additional track stopper **C**

C Additional track stopper

For adjustable mounting in top track. Zinc-alloy housing with steel spring and rubber buffer. Adjustable retaining force

Cat. No.	941.60.041
----------	------------

Order qty: 1 pc

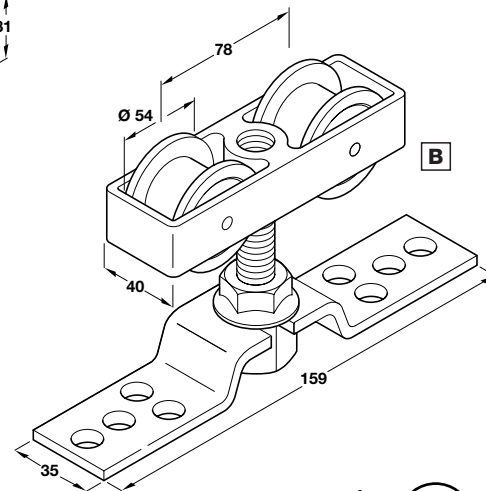
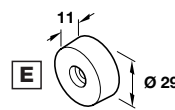

D Additional bottom guide

Rattle proof, for screw mounting to floor. Black plastic

Cat. No.	941.60.031
----------	------------

Order qty: 1 pc

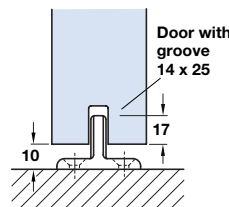

Alternative bottom guiding:

F Guide

Steel with nylon pilot

Cat. No.	407.49.111
----------	------------

Order qty: 1 pc (2 pcs required per door)

G Channel

Pre-drilled for countersunk screws. Anodised aluminium

Length	2.5 m	3.5 m
Cat. No.	940.41.250	940.41.350

Order qty: 1 pc (2.5 or 3.5 m length)

