

- **Application:** For top quality joinery and partitioning. Junior 40 is a vertically adjustable sliding door fitting for light to medium weight interior doors
- **Range:**
 - Max. door weight **40 kg**
 - Min. door thickness **22 mm**
 - Max. door height normally **2.1 m**
- **Hawa Junior 40 fitting set** comprises fittings **B, C, D** and **E**
- **Tracks are not included in the fitting set and must be ordered separately**
- Installation drawing reference **17689**

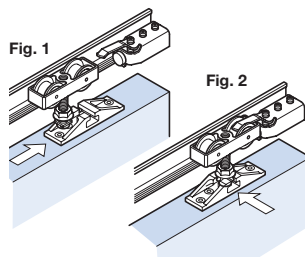

Easy to install
The two-way mounting plate allows the sliding door to be taken off or suspended in two different ways:

Fig. 1 - Side mounting
Fig. 2 - Front mounting



- For ancillary door fittings, locks, handles, bolts, seals, etc. see pages 4-6

A Junior 40 single top track

With screw holes for soffit fixing. Silver anodised aluminium

Length	2.0 m	3.0 m
Cat. No.	940.40.200	940.40.300

Order qty: 1 pc (2.0 or 3.0 m length)

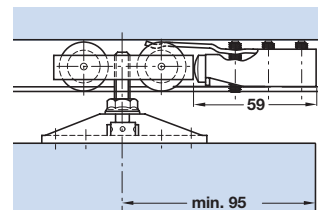
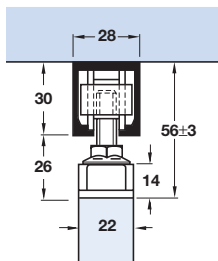

HAWA-Junior 40 fitting set

B Trolley hanger. Sleeve bearing mounted, high-grade polyamide tandem rollers. Aluminium carriage and zinc-alloy mounting plate. Complete with fastening materials

C Track stopper. For adjustable mounting in top track. Zinc alloy housing with steel spring and rubber buffer. Adjustable retaining force

D Guide. Rattle proof. For screw mounting to floor. Black plastic

E Rubber buffer. Screw fixing

For 1 door	
B Trolley hanger	2 pcs
C Track stopper	1 pc
D Guide	1 pc
E Rubber buffer	1 pc
Cat. No	940.40.001

Order qty: 1 set

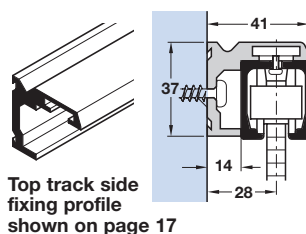

Top track side fixing profile shown on page 17

Two top tracks are mounted side by side for double or multiple doors

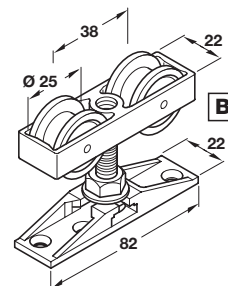
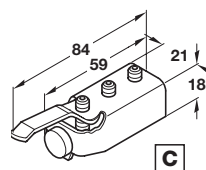

Important mounting note: If the sliding door is required to stop at both ends, we recommend installing an additional track stopper **C**

C Additional track stopper

For adjustable mounting in top track. Zinc-alloy housing with steel spring and rubber buffer. Adjustable retaining force

Cat. No	940.40.041
---------	------------

Order qty: 1 pc

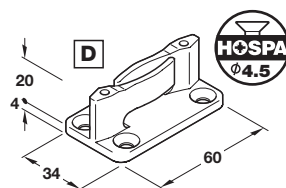
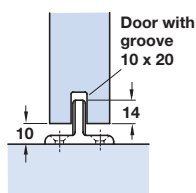

Track stopper positioned in top track.

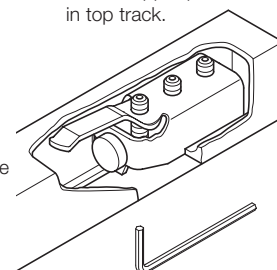

The retaining force can be adjusted with an allen key

Item F and G: Alternative light duty guiding with continuous aluminium channel:

F Guide. Light duty. Steel plate with nylon blade

Cat. No	409.12.990
---------	------------

Order qty: 1 pc (2 pcs required per door)

G Channel

Pre-drilled for countersunk screws. Bright aluminium

Length	2.1 m	3.0 m
Cat. No.	409.14.010	409.14.029

Order qty: 1 pc (2.1 or 3.0 m length)

