

Fittings for Straight Timber Cabinet Doors

Top Guides and Bottom Rollers

• Application:

Sliding door fittings for light duty applications with bottom rollers and upper guides
Suitable for general purpose furniture

• Range:

Maximum door weights **12 kg**
Minimum door thicknesses **12 mm**

• For ancillary door hardware i.e. locks, handles and bolts etc. refer to page 19

A Reversible track/channel

Press fit, with flanged edges and ribbed shoulder. For top and bottom of cabinet. Plastic

Length	Brown	White
3.0 m	404.14.104	404.14.702

Order qty: 1 pc (3.0 m length)

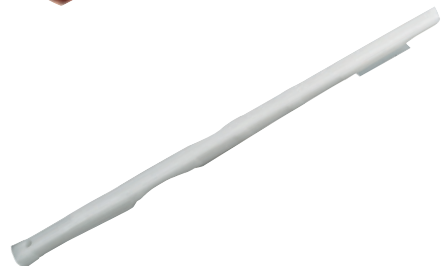
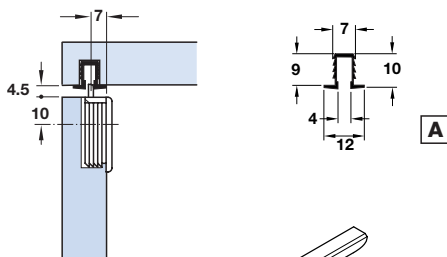

B Guide retainer

Natural coloured plastic. Spring loaded

Cat. No.	404.06.004
----------	------------

Order qty: 1 pc (order 2 pcs per door)

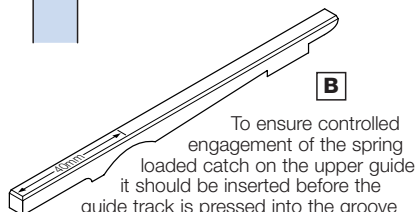

To ensure controlled engagement of the spring loaded catch on the upper guide it should be inserted before the guide track is pressed into the groove

C Guide, spring loaded

Press fit, then screw fixed. Brown plastic

Cat. No.	404.21.154
----------	------------

Order qty: 1 pc (order 2 pcs per door)

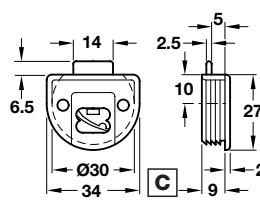
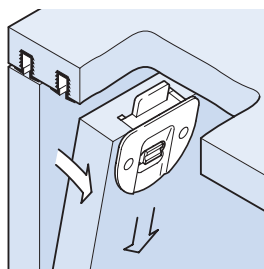

D Guide bolt

Press fit, then screw fixed. Lockable. Brown plastic

Cat. No.	404.21.109
----------	------------

Order qty: 1 pc (order 2 pcs per door)

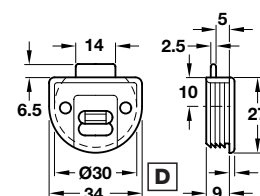
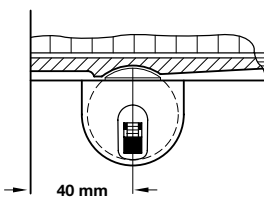

E Bottom roller

Press fit, then screw fixed. With double bearing mounted axle. Brown plastic

Cat. No.	404.22.106
----------	------------

Order qty: 1 pc (order 2 pcs per door)

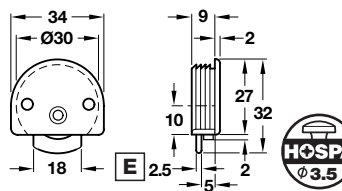
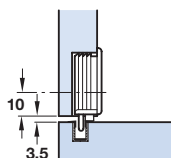

F Bottom roller

Recessed, then screw fixed. With double bearing mounted axle. Vertically adjustable ± 1 mm. Brown plastic

Cat. No.	404.22.151
----------	------------

Order qty: 1 pc (order 2 pcs per door)

