

# Fittings for Sliding Folding Cabinet Doors and Partitions

## Häfele System 6, for Two Overlay Doors

- **Application:** Suitable for residential and light duty commercial applications for pairs of overlay doors
- Economical and hence ideal for volume furniture manufacturers as well as bespoke cabinet makers
- **Range** Max. door weight **20 kg** per panel  
Door thickness **19 to 25 mm**  
Max. door width **450 mm**
- **Häfele System 6 fitting set for 2 doors** comprises fittings **B, C, D,** and **E**
- Fixing materials are included in the sets
- **Tracks are not included in the fitting sets and must be ordered separately**
- **For ancillary door fittings, handles, hinges and locks etc. refer to page 115**

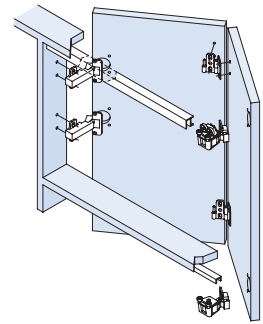

### A Top track

Pre-drilled for screw mounting. Silver anodised aluminium

Length	Cat. No.
3.0 m	409.91.930

Order qty: 1 pc (3.0 m length)

### Häfele System 6 fitting set

**B Upper trolley hanger.** Hinged and inset to opening (leading) edge of door. Nickel plated hinge and cup with black plastic body and nylon rollers

**C Centre hinge.** 'Drop' hinge type. Zinc alloy with steel pin

**D Adjustable centre hinge.** 'Drop' hinge type. Zinc alloy with steel pin

**E Lower roller guide.** Hinged and inset to opening (leading) edge of door. Nickel plated hinge and cup with black plastic body and nylon rollers

For 2 doors	
<b>B</b> Upper trolley hanger	1 pc
<b>C</b> Centre hinge	1 pc
<b>D</b> Adjustable hinge	1 pc
<b>E</b> Lower roller guide	1 pc
Cat. No.	409.90.000

Order qty: 1 set

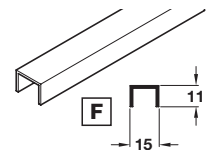
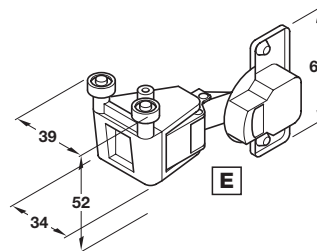
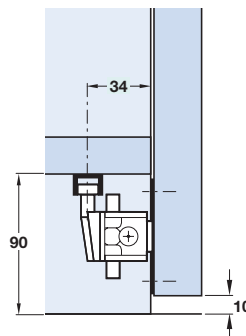
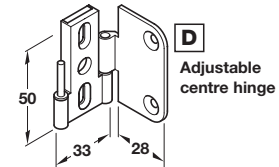
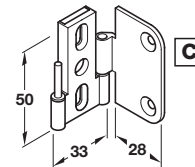
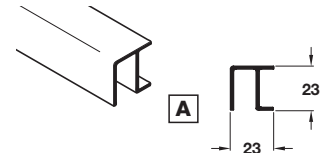
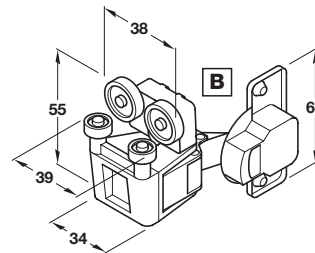
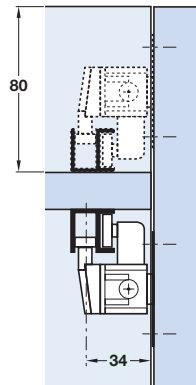

### F Bottom track

Pre-drilled for screw mounting. Silver anodised aluminium

Length	Cat. No.
3.0 m	409.90.020

Order qty: 1 pc (3.0 m length)



### G Frame to panel concealed hinges:

**For overlay doors:**

**Hinge,** 110° opening angle. 0 mm crank, sprung. Slide on arm. Ø 35 mm cup, screw fixing. Nickel-plated pressed steel

**Mounting plate,** 0 mm height. For slide on arms. Screw fixing. Nickel-plated zinc alloy and pressed steel

**Refer to the Complete Häfele catalogue for Furniture Fittings and Hardware for further information on hinges and mounting plates)**

For overlay doors	
Hinge	323.17.507
Mounting plate	323.80.706

Order qty: 1 pc

