



Stainless Steel Grade 316:

Stainless steel to EN standard No. 1.4401
ASTM/AISI 316

Spindle type

- Plain spindle
- Piercing spindle
- Slotted spindle
- Stabil spindle

See page 64 for details

Compatibility rating



For full explanation see page 2

A SNOWDON round section lever handles

- Pair of lever handles
- Grub screw fixing on 8 mm spindle
- Pair of concealed fixing roses
- **Unsprung**, for use with **heavy duty** followers
- Fixings included
- To suit doors **35-54 mm** thick
- 316 stainless steel
- Matching escutcheons available, see page 189
- Matching pull handles available, see page 137
- Spindle type, see page 64 for details
- For recommended locks, see **Section 2** pages 4-14

Ø 16 mm

Finish	Cat. No.
Satin stainless steel	902.20.640
Polished stainless steel	902.20.641

Order qty: 1 pair

Ø 19 mm

Finish	Cat. No.
Satin stainless steel	902.20.650
Polished stainless steel	902.20.651

Order qty: 1 pair

Ø 22 mm

Finish	Cat. No.
Satin stainless steel	902.20.660
Polished stainless steel	902.20.661

Order qty: 1 pair

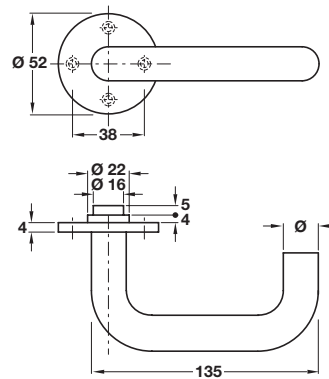

Satin stainless steel finish



B BEN NEVIS round section lever handles

- Pair of lever handles
- Grub screw fixing on 8 mm spindle
- Pair of concealed fixing roses
- **Unsprung**, for use with **heavy duty** followers
- Fixings included
- To suit doors **35-54 mm** thick
- 316 stainless steel
- Matching escutcheons available, see page 189
- Matching pull handles available, see page 137
- Spindle type, see page 64 for details
- For recommended locks, see **Section 2** pages 4-14

Ø 16 mm

Finish	Cat. No.
Satin stainless steel	902.20.670
Polished stainless steel	902.20.671

Order qty: 1 pair

Ø 19 mm

Finish	Cat. No.
Satin stainless steel	902.20.680
Polished stainless steel	902.20.681

Order qty: 1 pair

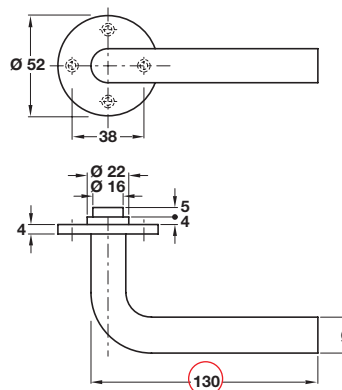

Item B.
Catalogue shows 135 mm
Correct dimension is
130 mm

Polished stainless steel finish



TCH-AI 2008, HUK. Dimensional data not binding. We reserve the right to alter specifications without notice.