

1

Compatibility rating

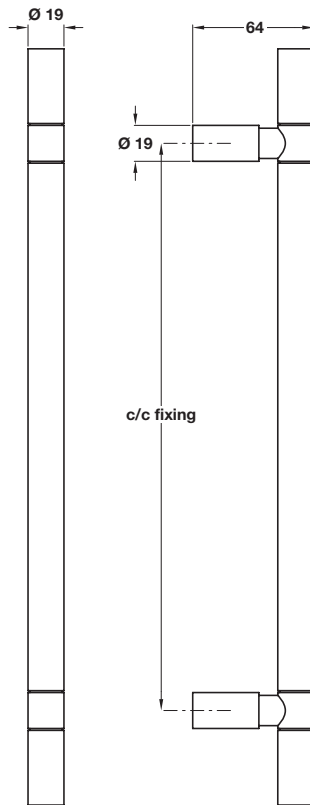

For full explanation see page 2



Satin/matt stainless steel finish



**A** SIERRA NEVADA pull handle

- Single pull handle
- Bolt through fixing
- M8 through fixing bolts included
- To suit doors up to **54 mm** thick
- Grade 316 stainless steel

c/c fixing	300 mm	425 mm	600 mm
Satin/matt stainless steel	903.01.160	903.01.162	903.01.164
Polished/matt stainless steel	903.01.161	903.01.163	903.01.165

Order qty: 1 pc

Example: Bolt through fixing

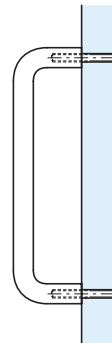

**B** SIERRA NEVADA pull handle

- Pair of pull handles
- Back to back fixing
- M8 through fixing bolts included
- To suit doors up to **54 mm** thick
- Grade 316 stainless steel

c/c fixing	300 mm	425 mm	600 mm
Satin/matt stainless steel	903.01.170	903.01.172	903.01.174
Polished/matt stainless steel	903.01.171	903.01.173	903.01.175

Order qty: 1 pair

Example: Back to back fixing

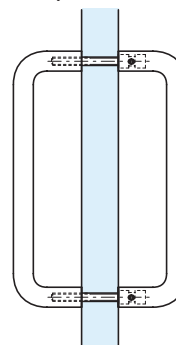

**C** Back to back fixings, glass

- To convert item **B** to glass door fixing
- Pair of nylon sheaths
- 4 x **Ø 19 mm** nylon washers
- Special M8 fixing bolts included
- To suit doors **8-18 mm** thick
- Ø 13 mm hole required

Cat. No.	909.00.900
----------	------------

Order qty: 1 set

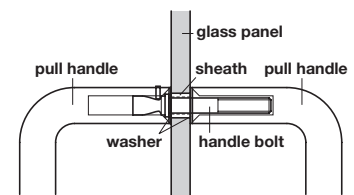
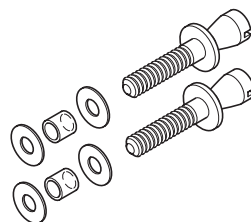

TCH-A1 2008, HUK. Dimensional data not binding. We reserve the right to alter specifications without notice.