

# Fittings for Pivot Sliding Cabinet Doors

## Accuride 1312, Horizontal or Vertical Use

50,000



### Accuride 1312 pivot sliding door fittings

- Horizontal and vertical use
- Door supports required when fitting horizontally
- Robust mounting plate for ease and security of door attachment
- Maximum door extension allows ease of hinge operation
- Unhanded design
- Quiet and easy movement
- 32 mm hole pattern
- Maximum door weight **5.5 kg**
- Door heights up to **900 mm**
- Panel thickness from **16-24 mm**
- Bright zinc-plated steel

Slide length	Extension length	Dim. A	Dim. B	Cat. No.
350 mm	257 mm	192	288	408.08.357
400 mm	307 mm	224	320	408.08.400
450 mm	357 mm	256	352	408.08.455
500 mm	407 mm	352	448	408.08.508
550 mm	457 mm	352	448	408.08.553
600 mm	507 mm	448	544	408.08.606

Order qty: 1 pair (per door)

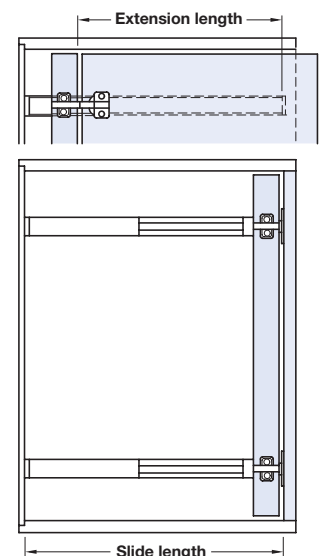
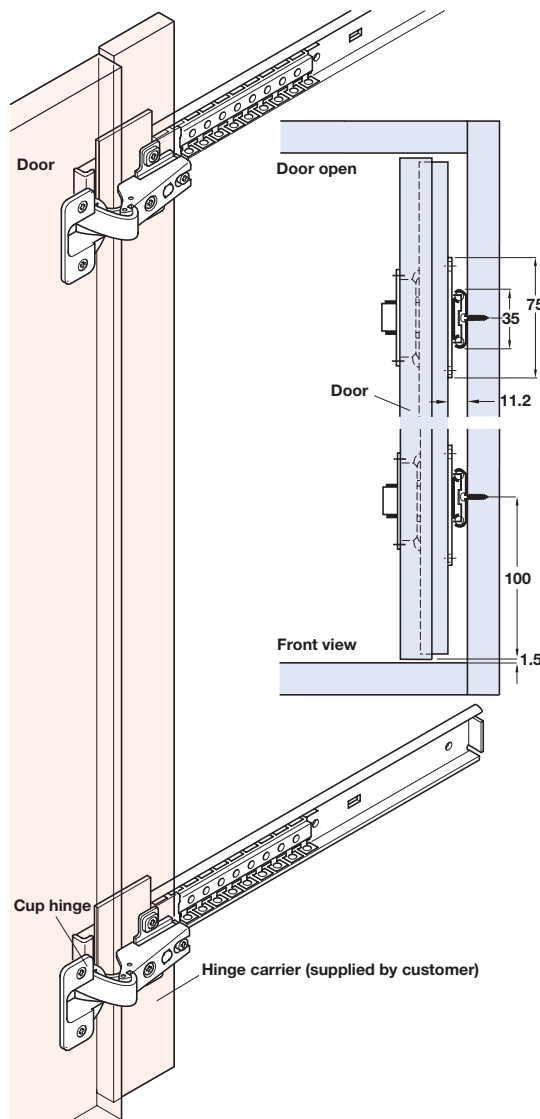

**Slide length =**  
Min. carcass depth required to install fitting

**Extension length =**  
Max. door width that can be withdrawn inside the carcass



### Concealed hinge, full overlay



- Opening angle **95°**
- Sprung
- Ø 40 mm screw fixing cup with click on arm
- Nickel-plated pressed steel cup and nickel-plated zinc alloy arm

Crank	Cat. No.
0 mm	322.13.630

Order qty: 1 pc (order 2 pcs per door)

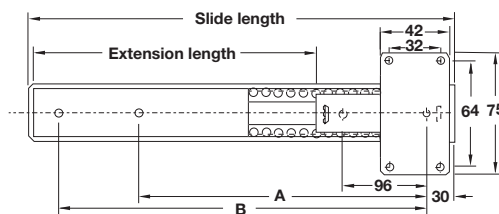

### Super compact cruciform mounting plate



- Screw fixing, for click-on system hinges
- Two part plate with external height adjustment
- Nickel-plated zinc alloy and pressed steel

Crank	Cat. No.
0 mm	322.85.750

Order qty: 1 pc (order 2 pcs per door)

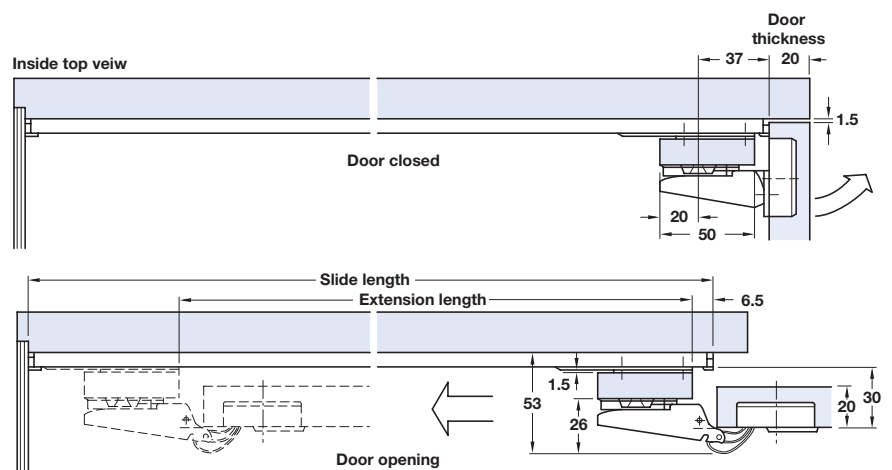

TCH-FF 2010, HUK. Dimensional data not binding. We reserve the right to alter specifications without notice.