

Tambour shutters and tracks

For cupboard or cabinet door requirements where space is at a minimum. The door shutter folds away neatly and is concealed when open. Can be used with or without counterbalancing mechanism.

Maximum size of tambour shutters as illustrated

Please note: The maximum height **must not exceed 1.2 m** without using item **A** counterbalancing mechanism

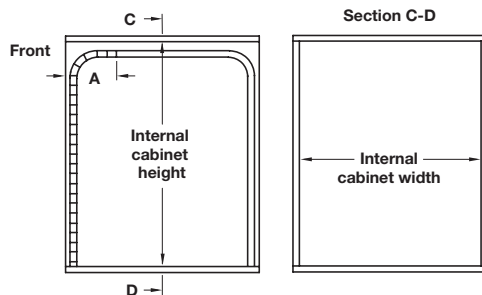
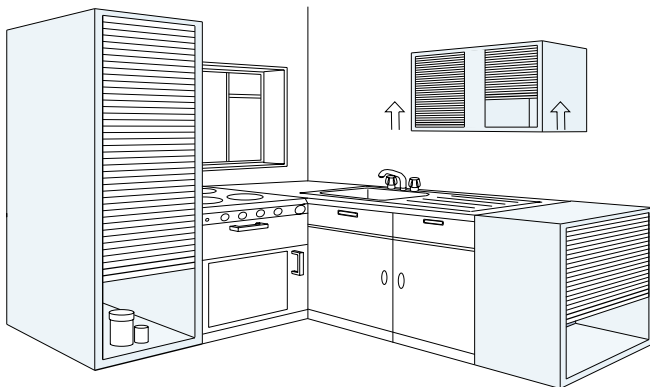

To calculate shutter dimensions:

Shutter length = Internal cabinet height + 30 mm

Ensure shutter is long enough to extend beyond the bend in the track when closed

Shutter width = Internal cabinet width + 14 mm

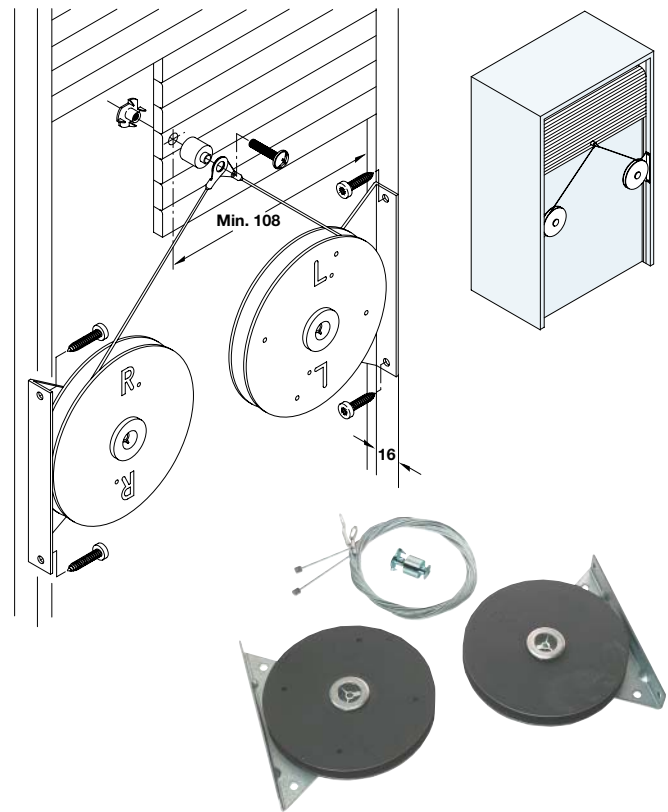
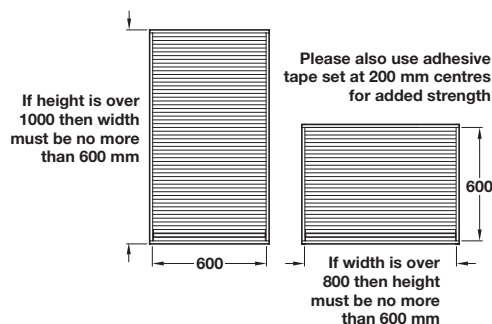

A Counterbalancing mechanism

- Adjustable spring loaded function
- Holds shutter in any position
- Shutter cannot be unintentionally opened or closed
- Suitable for shutter widths of minimum 216 mm to maximum 900 mm. **Please see diagram to the left**
- Maximum shutter travel 1.6 m
- A trial installation is advisable for heavy shutters. The installation instructions included with the set must be observed without fail
- Comprises:
 - 1x pair counterbalancing drums
 - 2x steel cables, each 1.6 m long with fastening eyes
 - 1x kit of fastening materials
 - 1x mounting instructions leaflet
- Galvanized steel drums; black plastic fittings

	Cat. No.
Counterbalancing mechanism	442.09.903

Order qty: 1 set

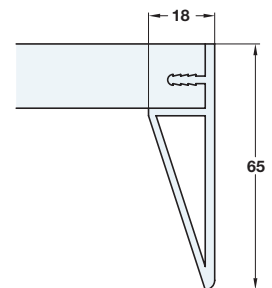

Stainless steel
Aluminium colour

B Tambour top trim

- Stainless steel

Illustration removed

Finish	Cat. No.
Stainless steel	442.64.904
Aluminium colour	442.64.004

Order qty: 1 pc