

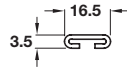

A C-profile locking bar

- For use with all central locking systems shown on page 6
- Galvanized steel



Length	Cat. No.
500 mm	234.87.916
533 mm	234.87.919
600 mm	234.87.925
800 mm	234.87.934
1000 mm	234.87.943
1300 mm	234.87.948
1500 mm	234.87.952

Order qty: 1 pc



B Bar retaining bracket

- With guide lug
- For use with C-profile bar A
- Galvanized steel

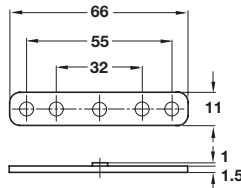

	Cat. No.
Bracket	234.87.989

Order qty: Multiples of 10 pcs



C Open bar guide

- Suitable for surface or recess mounting
- Galvanized steel

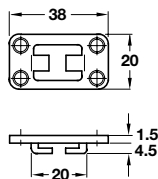

	Cat. No.
Open bar guides	237.23.006

Order qty: Multiples of 10 pcs



D Hexagonal section arresting pin

- For installation in C-profile bar A using the combination tool
- Nickel-plated steel

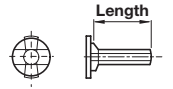

Length	Cat. No.
9.5 mm	237.22.714
13 mm	237.22.723
16 mm	237.22.732
19 mm	237.22.741
22 mm	237.22.750
25 mm	237.22.769
32 mm	237.22.778
38 mm	237.22.787
51 mm	237.22.796

Order qty: Multiples of 10 pcs

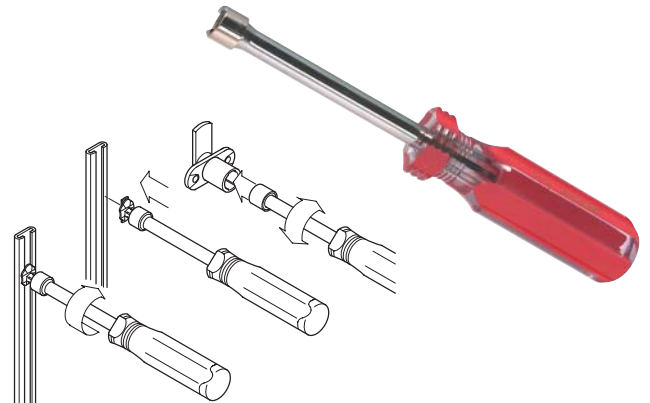

E Combination tool

- For installing arresting pins in bar A
- For operating the cylinder housings before a core is inserted and changing cam on cam locks
- Nickel-plated steel with plastic handle

	Cat. No.
Combination tool	006.36.653

Order qty: 1 pc

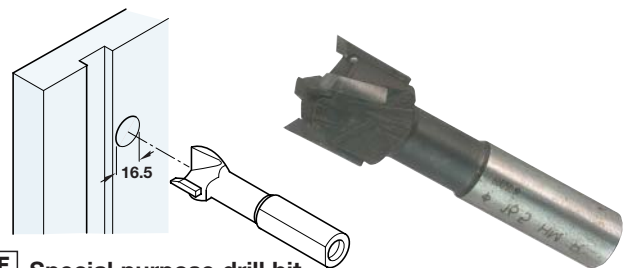

F Special purpose drill bit

- Ø 16.5 mm, suitable for all Module system cylinder housings
- Can be used in multi spindle drilling machines with 10 mm chuck, clockwise rotating
- Tool quality steel shank with carbide-tipped bit

	Cat. No.
Drill bit	001.24.194

Order qty: 1 pc

TCH-FF 2010, HUK. Dimensional data not binding. We reserve the right to alter specifications without notice.