

A Table top connecting fitting

- Press-fits into $\text{Ø } 8 \text{ mm}$ hole
- Especially suitable for extending tables with a central extension leaf
- Yellow chromated steel

	Cat. No.
Connecting fitting	642.51.243

Order qty: Multiples of 100 pcs

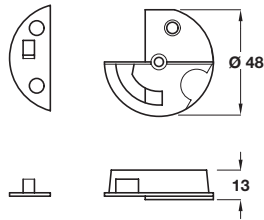
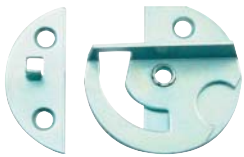

B Table top connector

- Screw mounted to underside of table top (flush or proud)
- Holds table top panels together
- Bright steel



	Cat. No.
Connector	642.48.920

Order qty: Multiples of 2 pcs

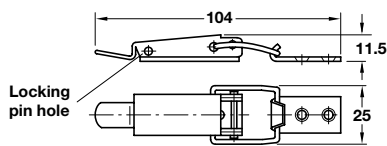

C Spring clip

- Screw fixing to underside of table top
- Galvanized steel



	Cat. No.
Spring clip	380.52.925

Order qty: 1 pc



Important note: Unless otherwise indicated fixing screws are not included and must be ordered separately.

The symbol shown next to the drawing indicates the type and size of screw required.

Fixing materials can be found in **Section 11** from page 3.

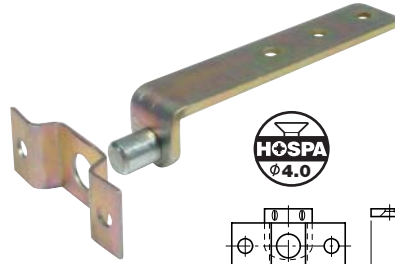

D Pivot bearing

- Screw fixing to underside of extension leaves
- This fitting enables a two-piece, folding extension leaf to be installed in an extending table with a fixed frame
- Yellow chromated steel

	Cat. No.
Pivot bearing	642.48.504

Order qty: 1 pair

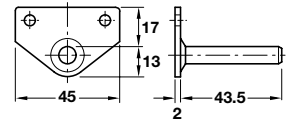

E Supporting bracket

- Screw fixing to table frame
- The cylindrical supporting lug, prevents the extension leaf becoming damaged on opening and closing
- Yellow chromated steel



	Cat. No.
Supporting bracket	642.48.513

Order qty: 1 pc

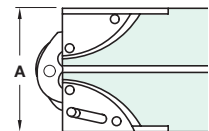
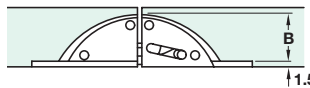
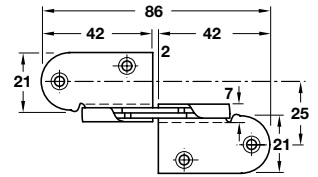

F Folding leaf hinge

- Recess-mounted
- For 19, 22 and 25 mm wood thicknesses
- Brass-plated steel



Wood thickness	Dim A	Dim B	Cat. No.
19 mm	46 mm	16 mm	341.30.508
22 mm	51 mm	19 mm	341.30.526
25 mm	59 mm	23 mm	341.30.544

Order qty: 1 pc