

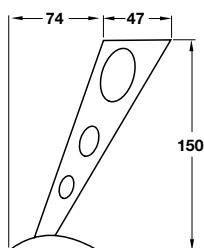

Important note: Unless otherwise indicated fixing screws are not included and must be ordered separately.

The symbol shown next to the drawing indicates the type and size of screw required.

Fixing materials can be found in **Section 11** from page 3.



A Furniture foot, 150 mm

- Screw fixing
- Aluminium coloured plastic coated steel



	Cat. No.
Furniture foot	634.13.930

Order qty: Multiples of 4 pcs

Carrying capacity is dependant on the type of material, size and weight of the construction

For insert sleeves to suit M8 threaded pin please refer to **Section 11** page 16 and 17



C Furniture foot

- With M8 threaded pin
- With white plastic guide
- With 20 mm height adjustment
- Aluminium

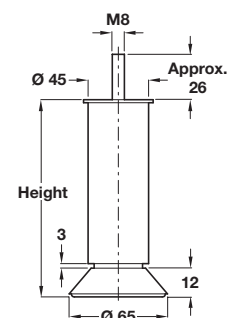

Height	Cat. No.
100 mm	634.62.584
120 mm	634.62.587
140 mm	634.62.588
160 mm	634.62.590
180 mm	634.62.592

Order qty: 1 pc

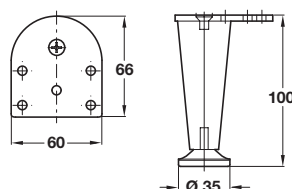

B Furniture foot, 100 mm height

- Screw fixing
- Matt nickel zinc alloy



	Cat. No.
Furniture foot	634.28.602

Order qty: Multiples of 2 pcs



D Furniture foot

- With M8 threaded pin
- With black plastic guide
- Aluminium

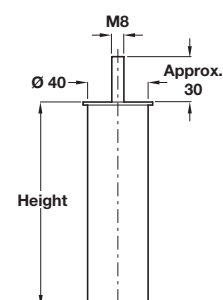

Height	Polished	Matt
40 mm	634.65.241	634.65.441
60 mm	634.65.243	634.65.443
80 mm	634.65.245	-
100 mm	-	634.65.447
120 mm	634.65.250	-
140 mm	634.65.253	634.65.453
160 mm	-	-
180 mm	-	634.65.457

Order qty: 1 pc