

Photograph shows castor with brake,
illustration shows castor without brake

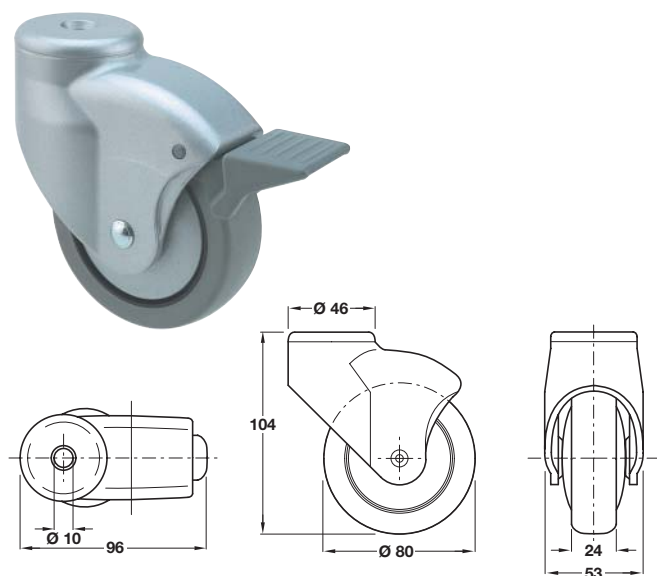

A Swivel castor

- Maximum load carrying capacity **70 kg** per castor
- Housing: Silver coloured RAL 9006 plastic
Wheel: Mid grey rubber
Brake: Mid grey plastic
- **Order Ø 10 mm pin separately**

	Without brake	With brake
Cat. No.	663.29.201	663.28.201

Order qty: 1 pc

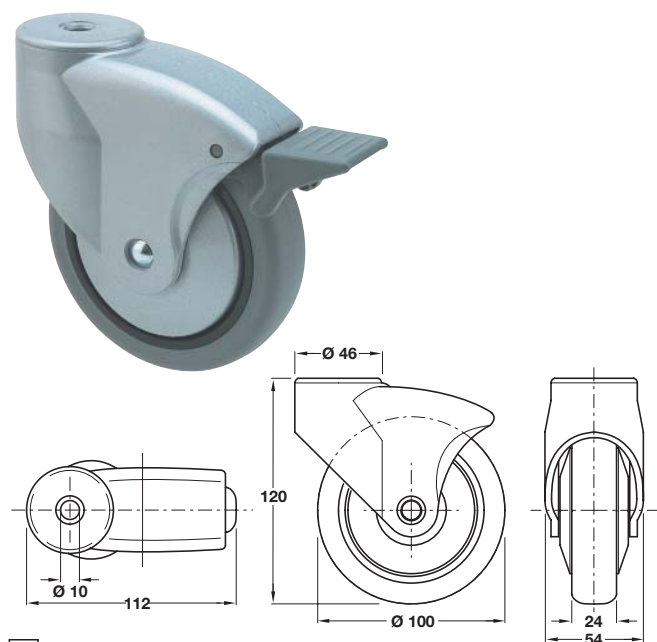

B Swivel castor

- Maximum load carrying capacity **70 kg** per castor
- Housing: Silver coloured RAL 9006 plastic
Wheel: Mid grey rubber
Brake: Mid grey plastic
- **Order Ø 10 mm pin separately**

	Without brake	With brake
Cat. No.	663.29.202	663.28.202

Order qty: 1 pc



C Pin, Ø 10 mm, with M10 thread

- M10 x 25 mm
- Steel

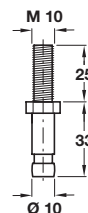

Finish	Cat. No.
Galvanized	660.92.920

Order qty: 1 pc



D Pin, Ø 10 mm, with circlip

- Must be used with item **E**
- Steel

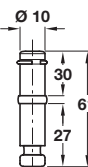

Finish	Cat. No.
Galvanized	660.92.930

Order qty: 1 pc



E Socket

- Must be used with item **D**
- Plastic

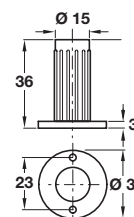

Finish	Cat. No.
Black	660.92.390

Order qty: 1 pc



F Pin, Ø 10 mm, with mounting plate

- Steel

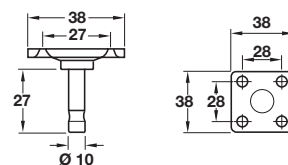

Finish	Cat. No.
Galvanized	660.92.950

Order qty: 1 pc