

Concealed Hinges

Duomatic 110° Hinge for use with PUSH opening system



PUSH door opening system

- For opening doors without handles
- System comprises Duomatic hinge, catch and locking part
- PUSH catch and locking part shown on page 44



A Duomatic hinge

- **Self opening hinge**, for use with PUSH door catch, shown on page 44, for opening doors without handles
- Opening angle 110°
- 0 mm crank
- Ø 35 mm cup
- Drilling pattern 48/6 mm
- Screw fixing cup
- Quick fitting arm
- Nickel plated steel cup and arm
- **Mounting plate** shown below, item B

Crank	Cat. No.
0	329.17.900

Order qty: 1 pc

Mounting screws

- Hospa chipboard screws, raised head, Ø 3.5 mm with cross slots
- Nickel-plated steel



Length	Cat. No.	Order qty
15 mm	015.55.639	1000
17 mm	015.55.648	1000
20 mm	015.55.657	1000

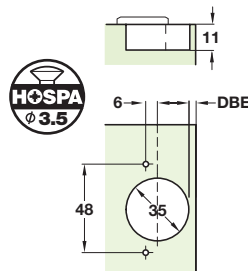

0 Crank

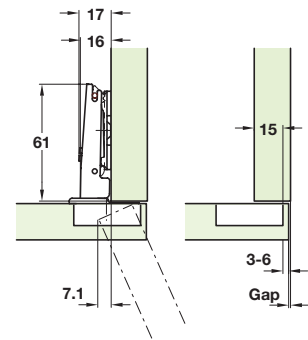

- DBE** = Distance of the bore from the edge of the door
- b** = Door thickness
- c** = Required gap
- e** = Coverage of the side (end) by door
- f** = Mounting plate thickness

Dimensions shown are calculated:
using ex-works setting
using mounting plate height 0 mm
when doors at max. opening angle

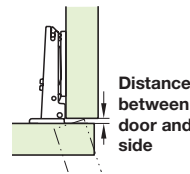
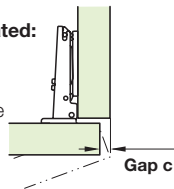

Full overlay

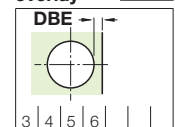

Gap c

Door thickness mm	DBE			
	3	4	5	6
16	0.5	0.5	0.5	0.5
17	0.7	0.7	0.7	0.7
18	0.9	0.9	0.9	0.9
19	1.2	1.2	1.2	1.2
20	1.5	1.5	1.5	1.5
21	1.8	1.8	1.8	1.8
22	2.4	2.1	2.1	2.1
23	3.7	2.7	2.6	2.5
24	5.1	4.1	3.1	3.0
25	6.5	5.5	4.1	3.5
26	7.8	6.8	5.4	4.4

These values will reduce for doors with a radius

Distance between door and side

Door thickness mm	DBE			
	3	4	5	6
16	0.0	0.0	1.1	2.0
17	0.0	0.0	1.3	2.3
18	0.0	0.3	1.6	2.5
19	0.0	0.6	1.8	2.8
20	0.2	0.9	2.1	3.1
21	0.5	1.2	2.3	3.3
22	0.8	1.4	2.6	3.6
23	1.1	1.7	2.9	3.8
24	1.4	2.0	3.1	4.1
25	1.7	2.3	3.4	4.3
26	1.9	2.6	3.6	4.6

These values will reduce for doors with a radius

B Duomatic SM cruciform mounting plate

- With pre-mounted Euro screws
- With ± 2 mm height adjustment and eccentric depth adjustment
- Nickel plated steel

Height	Cat. No.
3 mm	329.73.513

Order qty: 1 pc

