

Metal Drawer Sides

Grass Metal Drawer Sides, 149 mm High

See **Section 1**, page **76 onwards**, for Drawer Inserts

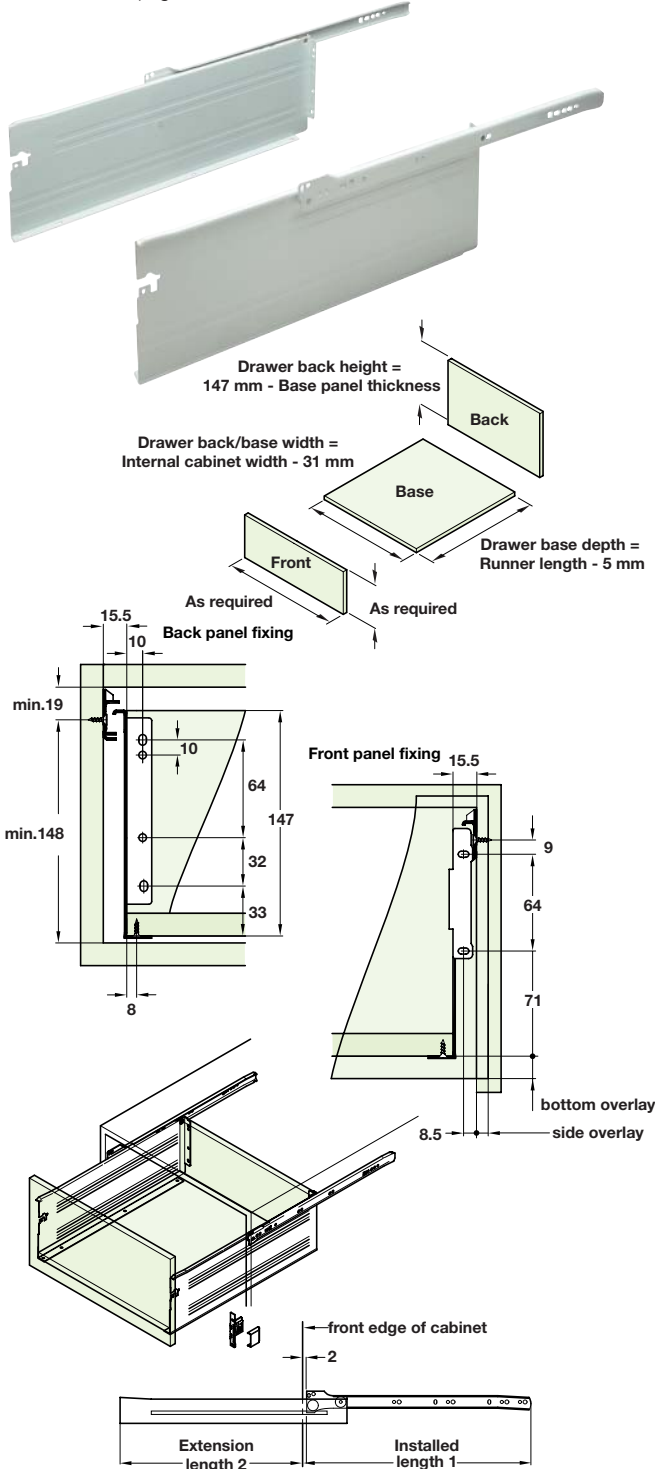

A Metal drawer sides, 149 mm high

- Complete with self closing runners with nylon rollers
- Five depths available
- To convert to an internal drawer, use alternative front fixing components
- White RAL 9010 epoxy coated steel

Installed length 1	Extension length 2	Cat. No.
350 mm	278 mm	555.65.735
400 mm	315 mm	555.65.740
450 mm	365 mm	555.65.745
500 mm	415 mm	555.65.750
550 mm	465 mm	555.65.755

Order qty: 1 pair

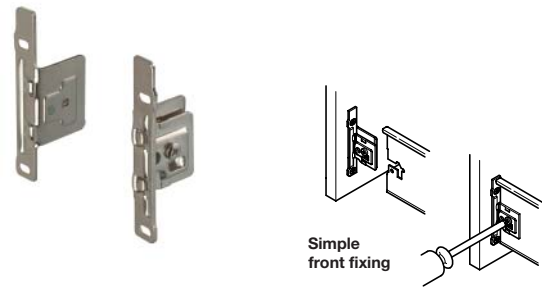

B Drawer front fixing components

- For use with drawer sides 53, 85, 117 and 149 mm
- Screw fixing
- Nickel-plated steel

For drawer sides height	Cat. No.
53 mm	555.62.921
85, 117 and 149 mm	555.62.920

Order qty: 1 pair

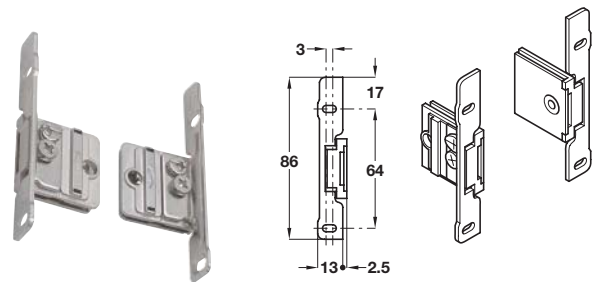

C Drawer front fixing components

- For use with drawer sides 85, 117 and 149 mm
- Clip-on fixing
- Zinc-plated steel

Finish	Cat. No.
Zinc-plated steel	555.62.925

Order qty: 1 pair



D Cover cap

- To conceal drawer front fixing components
- White RAL 9010 plastic

Colour	Cat. No.
White	555.62.930

Order qty: Multiples of 10 pcs