

Shelf Supports

Plug In Shelf Supports for Ø 5 and Ø 6 mm Holes

*Load carrying capacity applies to 4 shelf supports bearing an evenly distributed load. Testing was carried out according to DIN EN 1727 "Mechanical safety requirements for shelf supports"

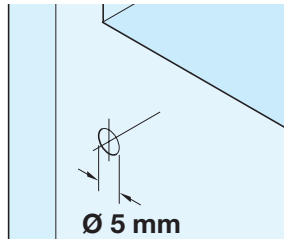
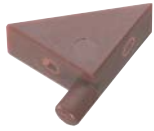

A Shelf support, plug in

- Provides additional screw-fixing of side panel and shelf
- For Ø 5 mm hole
- Load carrying capacity **80 kg***
- Plastic

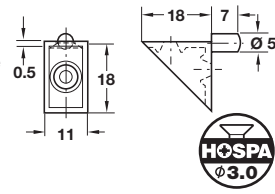

Finish	Cat.No.
Brown	283.50.101

Order qty: Multiples of 100 pcs

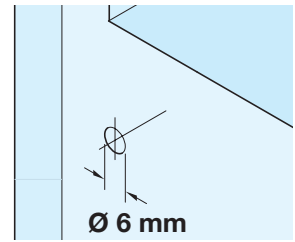

D Shelf support, plug in

- With grooved plug
- For Ø 6 mm hole
- Load carrying capacity **60 kg***
- Plastic

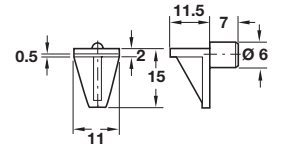

Finish	Cat. No.
Brown	283.63.108
Beige	283.63.402
White	283.63.706

Order qty: Multiples of 100 pcs

5

Shelf Supports and Brackets

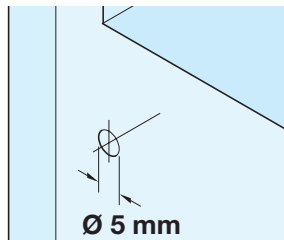

B Shelf support, plug in

- With plug and spring clip
- For Ø 5 mm hole
- Load carrying capacity **80 kg***
- Plastic

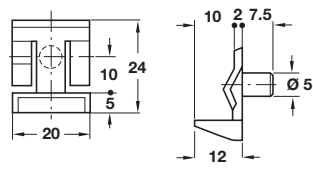

Finish	Cat. No.
Brown	282.33.105
White	282.33.703

Order qty: Multiples of 100 pcs

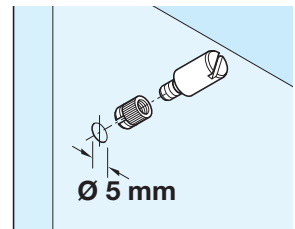

E Shelf support, plug in

- With M4 thread for installation in spreading dowel **G**
- Load carrying capacity **80 kg***
- Steel

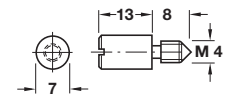

Finish	Cat. No.
Nickel-plated	282.39.705

Order qty: Multiples of 100 pcs



C Shelf support, plug in

- For Ø 6 mm hole
- Load carrying capacity **60 kg***
- Plastic

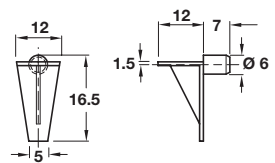

Finish	Cat. No.
Transparent	283.63.500

Order qty: Multiples of 100 pcs

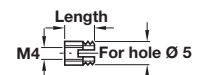

F Sleeve, M4 internal thread

- For Ø 5 mm hole
- For use with **E**
- Bright brass

Length	Cat. No.
8 mm	051.45.004

Order qty: Multiples of 100 pcs

TCH-FF 2010, HUK. Dimensional data not binding. We reserve the right to alter specifications without notice.