

- **Rondorfix** range of knock down fittings:
Housings have eccentric fitting
Bolts are available for direct fixing or with dowel or sleeve, shown below and on page 40

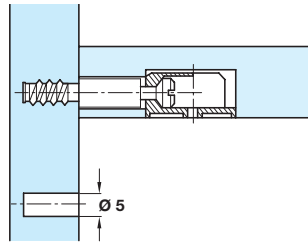

Connecting bolt with special thread for direct installation in $\varnothing 5$ mm hole

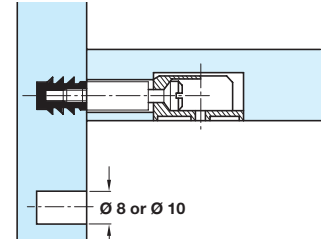

Connecting bolt with M6 thread for use in dowel or sleeve for push-fit or press-fit fastening in $\varnothing 8$ or $\varnothing 10$ mm hole

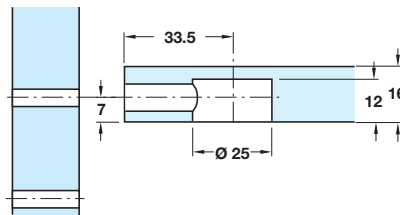

A Rondorfix eccentric housing

- For wood thicknesses from 16 mm
- Without flanged rim, **with bolt recess**
- Zinc alloy

Finish	Cat. No.
Bright	262.75.061

Order qty: Multiples of 100 pcs

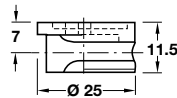

B Rondorfix eccentric housing

- For wood thicknesses from 16 mm
- Without flanged rim, **without bolt recess**
- Zinc alloy

Finish	Cat. No.
Bright	262.75.089

Order qty: Multiples of 100 pcs

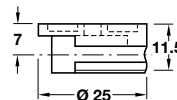

- **Connecting bolts** with special thread, for installation in $\varnothing 5$ mm pre-drilled holes

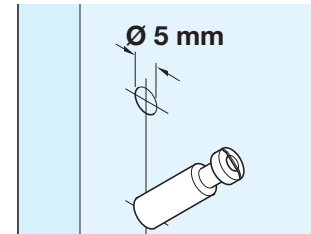
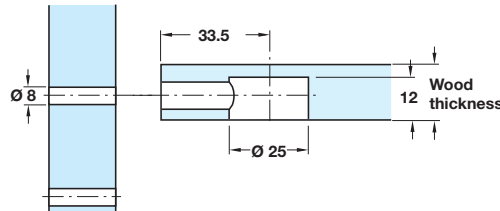

C Rondorfix connecting bolt

- With special thread
- Screws directly into $\varnothing 5$ mm holes
- Steel

Drilling distance B	33.5 mm
Bright	262.75.277

Order qty: Multiples of 100 pcs

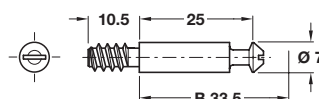

TCH-FF 2010, HUK. Dimensional data not binding. We reserve the right to alter specifications without notice.