

A Magnetic catch

- Screw fixing
- Plastic
- **Counterplate with finger pull** must be ordered separately

Pull (approx.)	4 kg
Finish	Cat. No.
Black	246.26.346

Order qty: 1 pc

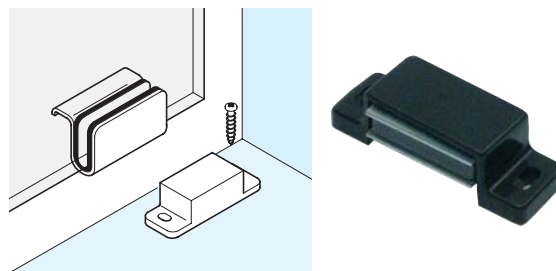
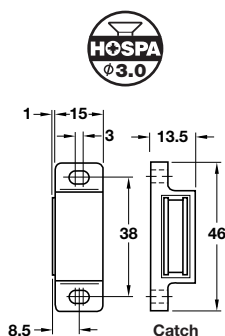

After removing the backing foil, attach the foam liner to the glass door, then push the counterplate or finger-pull over the liner

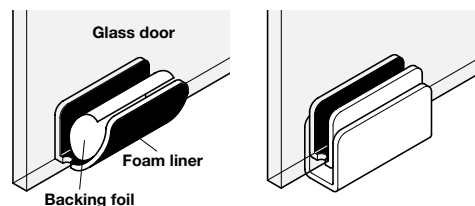

B Counterplate

- For use with **glass doors 4-6 mm** thick
- Use with catches shown on page **190**
- Steel plate, self adhesive foam inner

Finish	Cat. No.
Chrome-plated	245.66.211
Black	245.66.311

Order qty: 1 pc

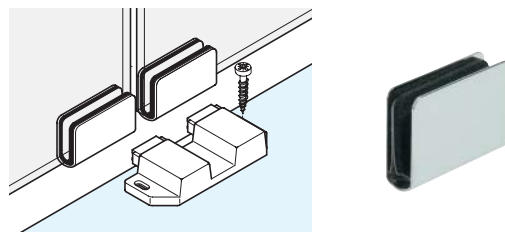
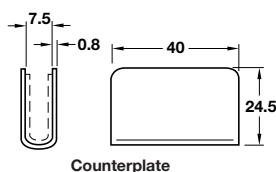

C Counterplate with finger pull

- For use with **glass doors 4-6 mm** thick
- Use with the catch shown above and those on page **190**
- Steel plate, self adhesive foam inner

Finish	Cat. No.
Chrome-plated	245.66.221
Black	245.66.321

Order qty: 1 pc

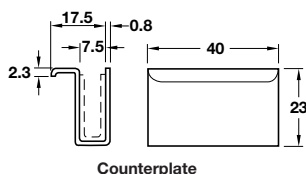

D Counterplate Ø 14 mm

- For use with **wooden doors**
- For use with **A, B** and **C** on page **190**
- Screw fixing
- Steel

Finish	Cat. No.
Galvanized	246.03.790

Order qty: Multiples of 100 pcs

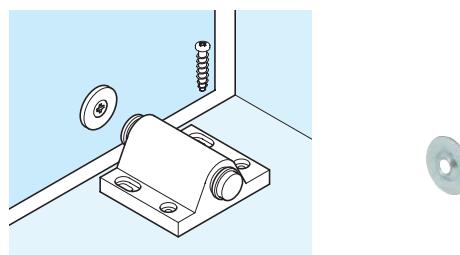
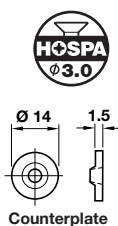

E Counterplate

- For use with **wooden doors**
- For use with **D** and **E** on page **190**
- Screw fixing
- Steel

Finish	Cat. No.
Galvanized	246.26.793

Order qty: Multiples of 100 pcs

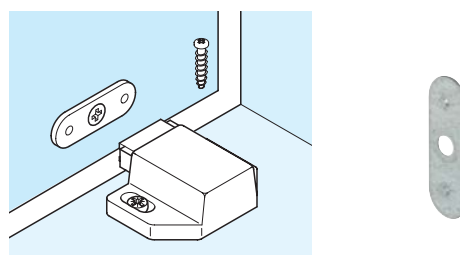
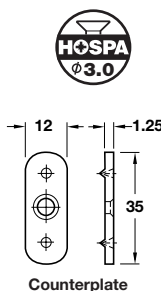

TCH-FF 2010, HUK. Dimensional data not binding. We reserve the right to alter specifications without notice.