

A Magnetic catch

- For use on metal cabinets
- Screw fixes through a wall panel
- With M5 pin
- Catch: Fixed
- Counterpiece: Fixed, screw fixing
- All metal catch and steel counterpiece

Pull (approx.)	3 kg
Cat. No.	246.96.008

Order qty: 1 pc

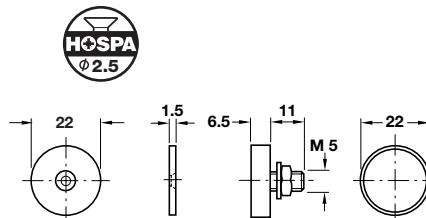

B Flat magnet

- Screw fixing
- M5 countersunk screw included
- No counterpiece required, ideal for use in metal cabinets
- Galvanized steel case

Pull (approx.)	3.6 kg
Cat. No.	246.86.025

Order qty: 1 pc

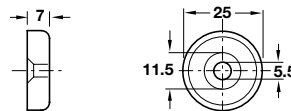

C Flat magnet

- Suitable for gluing
- No counterpiece required, ideal for use in metal cabinets
- Galvanized steel case

Pull (approx.)	4 kg
Cat. No.	246.88.025

Order qty: 1 pc

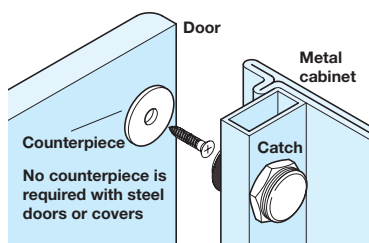
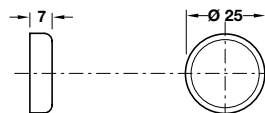

D Magnetic catch

- Suitable for box frame metal cabinets
- Fixes with tightening nut through a wall or panel
- Catch: Fixed
- Counterpiece: Fixed
- All metal catch and steel counterpiece

Pull (approx.)	7 kg	10 kg
Cat. No.	246.95.010	246.95.020

Order qty: 1 pc

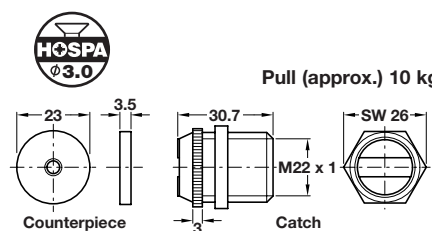
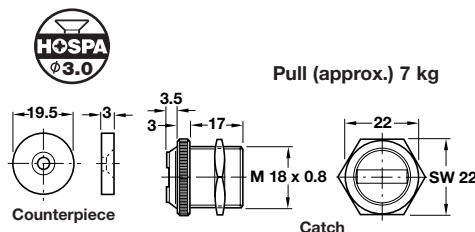

TCH-FF 2010, HUK. Dimensional data not binding. We reserve the right to alter specifications without notice.