

- **Two lever bit sizes** are offered which accommodate all locks shown in the catalogue
 - To choose a key from these two pages suitable for your choice of lock:
- Ensure the **lever bit** matches the recommendation given for your chosen lock
- Use the door thickness table to correctly select the **effective shank length** you require

Choice of lever bit size:

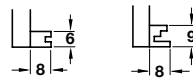

Effective shank length:

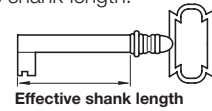

Door thickness	16 - 17 mm	18 - 20 mm	21 - 22 mm
Shank length for:			
Rim, inlaid and mortice locks	30 mm	30 mm	35 mm
Lever bit espagnolette locks	35 mm	40 mm	40 mm



A Zinc alloy key

- With 30 mm effective shank length

Finish	Cat. No.
Polished nickel-plated	204.11.787
Polished brass-plated	204.11.581

Order qty: 1 pc



B Zinc alloy key

- With 35 mm effective shank length

Finish	Cat. No.
Polished brass-plated	200.68.580
Burnished brown	200.68.188

Order qty: 10 pcs



C Zinc alloy key

- With 38 mm effective shank length

Finish	Cat. No.
Polished brass-plated	201.88.587
Burnished brown	201.88.185

Order qty: 1 pc



D Zinc alloy key

- With 30 mm effective shank length

Finish	Cat. No.
Polished nickel-plated	204.12.780
Matt nickel-plated	204.12.686
Polished brass-plated	204.12.580

Order qty: 1 pc



E Zinc alloy key

- With 40 mm effective shank length

Finish	Cat. No.
Polished nickel-plated	204.17.789
Polished brass-plated	204.17.583

Order qty: 10 pcs



Drilling diagram

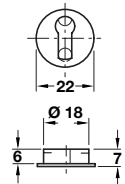
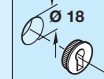

F Zinc alloy escutcheon

- To fit into Ø 18 mm aperture
- Use a flat bladed screwdriver to force slots in

Finish	Cat. No.
Matt nickel-plated	181.07.607
Polished brass-plated	181.07.803
Burnished brown	181.07.107

Order qty: 1 pc

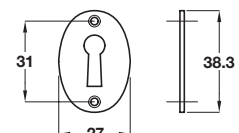

G Brass escutcheon

- Face fixing
- Fixing screws included

Finish	Cat. No.
Antique brass	120.83.801

Order qty: 1 pc