



Wardrobe rail, Ø 25 mm

- 1.2 mm wall thickness
- Steel



Finish	Cat. No.
Polished brass	801.11.841
Nickel-plated	801.11.741

Order qty: Multiples of **2.5 metres**



Wardrobe rail, Ø 25 mm

- 1.2 mm wall thickness
- 870 mm length
- Steel



Finish	Cat. No.
Polished chrome-plated	801.30.216

Order qty: 1 length



Discontinued
For 801.12.213 use alt. no. 801.12-0001

Wardrobe rail, Ø 25 mm

- 0.7 mm wall thickness
- Steel



Finish	Cat. No.
Chrome-plated	● 801.12.213

Order qty: Multiples of **2.5 metres**

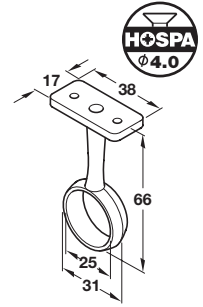

Rail centre support

- Screw mounted to the underside of a shelf
- For use with Ø 25 mm wardrobe rails
- Zinc alloy

Finish	Cat. No.
Polished brass	● 802.02.525
Chrome-plated	802.02.250

Order qty: 1 pc

Discontinued ●
Discontinued when stock = 0 +

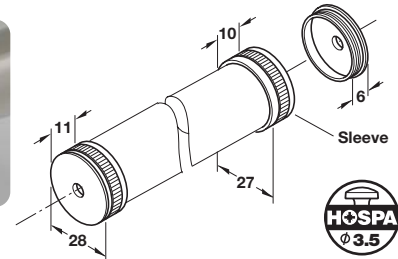

Rail end support

- Ø 28 mm, for use with Ø 25 mm wardrobe rails
- Set consists of: 1x one part end support, 1x two part end support
- The sleeve is pre-installed on the rail, then screwed onto the side panel support
- Brass

Finish	Cat. No.
Nickel-plated	803.51.757
Dull brass	803.51.855

Order qty: 1 set

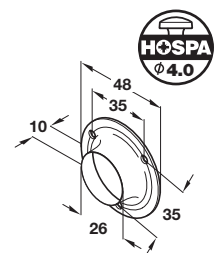

Wardrobe rail socket

- For use with Ø 25 mm wardrobe rails
- Steel

Finish	Cat. No.
Chrome-plated	803.53.220

Order qty: 1 pc