

A Worktop connecting bolt

- Eliminate the need for surface mounted worktop joining strips
- Comprises: 1x bolt, 2x wings
- Galvanized steel

Finish	Cat. No.
Galvanised steel	262.96.990

Order qty: Multiples of 10 pcs

Dimensions table

Bolt length	65 mm	150 mm
Dim. X	32-41 mm	75-84 mm

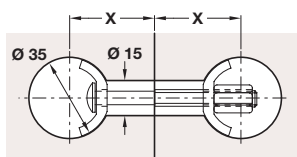

B Worktop connecting bolt

- Eliminate the need for surface mounted worktop joining strips
- The nut is tightened onto the bolt pressing the caps against the walls of the Ø 35 mm holes and pulling the two worktops or panels together
- Comprises: 1x bolt for 65 or 150 mm installation, 2x curved caps, 1x tightening nut
- Galvanized steel

Length	65 mm	150 mm
Cat. No.	262.96.211	262.96.220

Order qty: Multiples of 50 pcs

ZIPBOLT and ZIPTOOL

Save time and decrease production costs using the practical and innovative range of ZIPBOLTS and ZIPTOOLS

Fast and easy to install making joining work/countertops, furniture and staircases quick and clean

Produce strong joints with minimum fuss and no external clamping, protecting work from costly assembly damage

FEATURES:

ZIPTOOL is made from hardened tool steel for long life

ZIPBOLT can be tightened using cordless drill, spanner or hand tightened with screwdriver (place ZIPTOOL in hexhead shaft)

Use torque settings on cordless drill

The nut is tightened onto the bolt pressing the caps against the walls of the Ø 35 mm holes and pulling the two worktops or panels together

Dimensions table

Bolt length	85 mm	178 mm
Dim. X	38-40 mm	80-82 mm

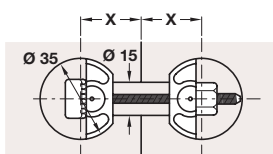

C Zipbolt

- Eliminate the need for surface mounted worktop joining strips
- Hardened tool steel and plastic
- Order Ziptool separately

Bolt length A	Ziptool	Cat. No.
85 mm	Mark 2	262.96.980
178 mm	Mark 2	262.96.981

Order qty: Multiples of 10 pcs

Dimensions table

Dim.	KD Maxi	KD Midi
Ø A	35 mm	35 mm
B	64 mm	64 mm
D	31 mm	21 mm
Ø F	8 mm	6 mm
Ø H	12 mm	10 mm

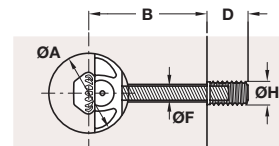

D KD zipbolt

- Eliminate the need for external clamping while adhesive sets
- Instantly holds the furniture components tightly in position. Used in conjunction with dowels and liquid adhesives it allows all legs or furniture components to be assembled at once
- Hardened tool steel and plastic
- Order Ziptool separately

Bolt type	Ziptool	Cat. No.
KD Maxi	Mark 2	262.96.970
KD Midi	Mark 2	262.96.971

Order qty: Multiples of 10 pcs

Dimensions table

Dim.	ST Maxi	ST Midi
Ø A	25 mm	25 mm
B	50-60 mm	50-60 mm
D	31 mm	21 mm
Ø F	8 mm	6 mm
Ø H	12 mm	10 mm

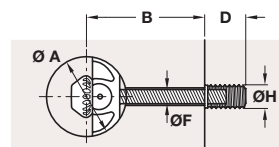

E ST zipbolt

- For use in construction of staircases
- A fast and efficient way to connect handrail to handrail or handrail to post, improving joint strength, precision and installation speed
- Hardened tool steel and plastic
- Order Ziptool separately

Bolt type	Ziptool	Cat. No.
ST Maxi	Mark 2	262.96.960
ST Midi	Mark 2	262.96.961

Order qty: Multiples of 10 pcs

F Zip tool

- For use with zip bolts
- Steel

Size	Cat. No.
Mark 2	262.96.989

Order qty: 1 pc

