

Suspension fitting

- Half-circle aperture with serrated edge
- Recess mounted
- White plastic

Ø mm	Cat. No.
16 mm	290.50.720

Order qty: Multiples of 100 pcs

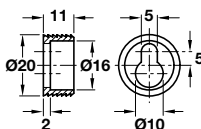

Suspension fitting

- Recess mounted keyhole slot
- White plastic

Ø mm	Cat. No.
16 mm	290.51.720

Order qty: Multiples of 100 pc

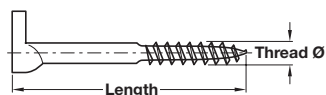

Screw hook

- With cross slot. For machine assembly
- Galvanized steel
- Use wall plugs for 100 mm length screw hooks

Hook length	Thread Ø	Cat. No.
50 mm	5.2 mm	057.05.905
65 mm	5.8 mm	057.05.906
80 mm	5.8 mm	057.05.908
100 mm	5.8 mm	057.05.910

Order qty: 1 pc

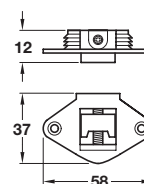

Concealed bracket, with embedded bracket

- For use with screw on hook shown below
- Adjustable coupling for fastening panels and mirrors
- A through hole from the top end panel allows you to adjust the bracket and get the panel perfectly level
- Enables panels to be adjusted, removed and secured again with extreme ease
- Fixings not included
- Nylon box with steel hooks

Finish	Cat. No.
Black	294.04.301
Ø 6 mm screw hook, with wall plug	057.05.906

Order qty: 1 pc

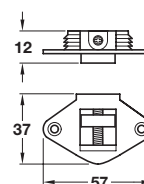
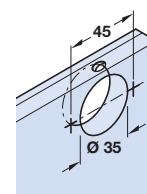

Concealed bracket, with external bracket

- For use with wall plate shown below
- Adjustable coupling for fastening panels and mirrors
- A through hole from the top end panel allows you to adjust the bracket and get the panel perfectly level
- Enables panels to be adjusted, removed and secured again with extreme ease
- Fixings not included
- Nylon box with steel hooks

Finish	Cat. No.
Black	291.04.301
Wall plate	290.08.921

Order qty: 1 pc