

**Foot operated door openers**

The pedal is mounted underneath the front edge of the cabinet floor with the counterplate on the inside of the door.

Light foot pressure on the pedal releases the magnetic catch and causes the spring fastened between the cabinet floor and the base shelf to pull base shelf and door forward out of the cabinet.



**Foot operated door opener**

- For door front fixing cabinets
- Includes pedal with magnetic catch, counterplate and draw spring
- Cat. No. 502.87.000 - Plastic metallic paint coated pedal with black lacquered steel counterplate
- Cat. No. 502.15.220 - Matt galvanised aluminium pedal with black lacquered steel counterplate

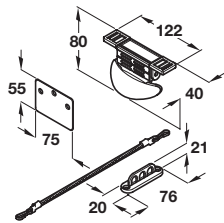

Usage	Cat. No.
For light weight bins	502.87.000
For heavier weight bins	502.15.220

Order qty: 1 pc



**Heavy duty foot pedal for light weight bins**

- For door front fixing cabinets
- Includes pedal with magnetic catch, counterplate and draw spring
- Plastic aluminium effect metallic paint coated pedal with black lacquered steel counterplate

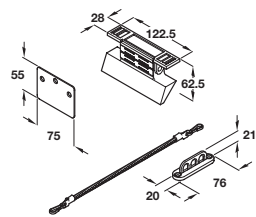

Usage	Cat. No.
For medium sized bins	502.15.260
For tall sized bins	502.15.250

Order qty: 1 pc



**Foot operated door opener**

- For hinged door cabinets
- Includes pedal with magnetic catch, counterplate and spring-loaded roller arm
- Light foot pressure on the pedal releases the magnetic catch and causes the spring-loaded roller arm to push the door open. The waste bin does not swing out with the door unless the bin is door mounted or has a follower fitted.
- Brown plastic pedal, black lacquered steel counterplate and white plastic spring loaded roller arm
- **Note:** Not for use in commercial high volume use such as doctors and dentist surgeries

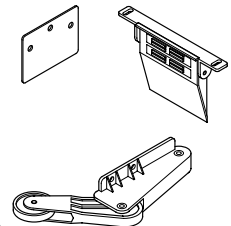

Cat. No.
Door opener

Order qty: 1 pc

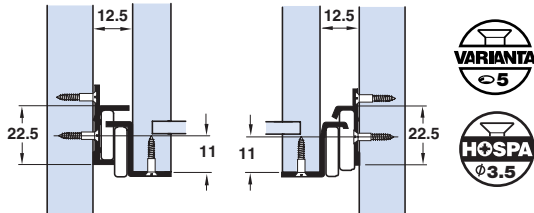

**Roller runners**

- Load carrying capacity 20 kg
- Self closing
- 500 mm installed length
- 400 mm extension length
- Cream-white epoxy coated steel



Cat. No.
Roller runners without front bracket

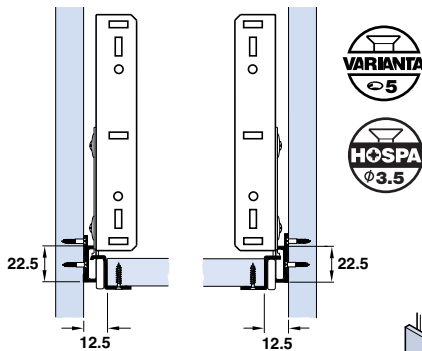

Cat. No.
Roller runners with front bracket

Order qty: 1 pair