

### A Headrail

- 3 m lengths, Ø 21.3 mm
- Fixed over divisions and doors
- Order socket, hanger and corner piece separately, as required
- Stainless steel, grade 316

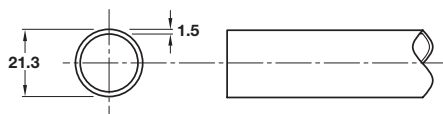

Finish	Cat. No.
Satin stainless steel	980.34.420

Order qty: 1 pc

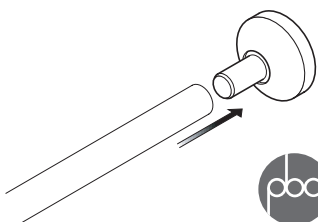

### B Wall to headrail socket

- Secures headrail to wall
- Press fit headrail onto connecting plug
- Fixings are included
- Stainless steel, grade 316 and galvanized steel connecting plug

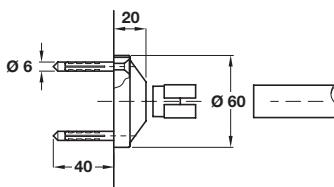

Finish	Cat. No.
Satin stainless steel	980.34.370

Order qty: 1 pc

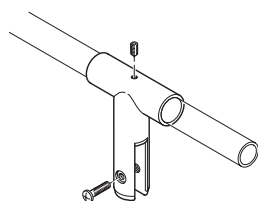

### C Hanger

- Secures headrail to board division panel
- Slides over headrail and secured by fixings
- Fixings included
- Stainless steel, grade 316

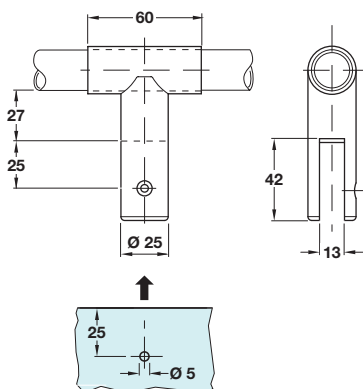

Finish	Cat. No.
Satin stainless steel	980.34.310

Order qty: 1 pc

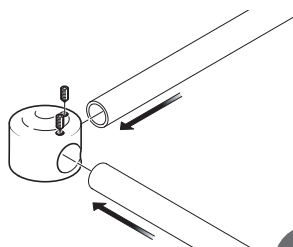

### D Corner piece

- Secures headrail at 90°
- Fixings included
- Stainless steel, grade 316

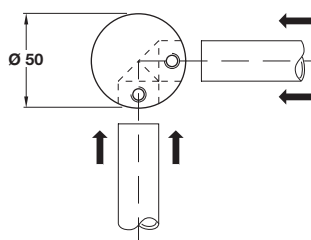

Finish	Cat. No.
Satin stainless steel	980.34.400

Order qty: 1 pc

5