

# Maxifix Universal Connectors

Dimensions in mm

- **Universal connector Maxifix**
- Individual connector to **drill in** for very strong connections with a high load capacity of wooden components, **minimum wood thickness of 24 mm**
- Wide range of applications
- Long tightening distance and rapid tightening with an allen key SW6 or cross slot PZ 3
- Can be tightened using an electric screw driver (bit allen key SW6 or cross slot PZ3)

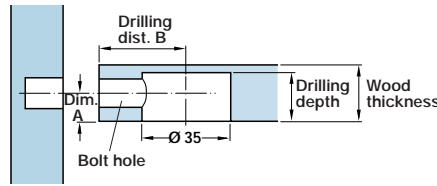

**Bolt hole** = Ø 10 mm  
**Drilling depth** = 1/2 wood thickness + 7.5 mm<sup>+0.5</sup>  
**Distance A** = 1/2 wood thickness  
**Drilling dist. B** = optional between **B 35** (35 mm) or **B 55** (55 mm), drilling distance from housing centre to panel front edge

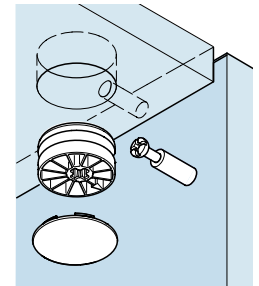

- **A Maxifix housings**
- Wide range of applications
- For wood thickness **from 24 mm**
- Drilling depth: 1/2 wood thickness + 7.5 mm
- Zinc alloy

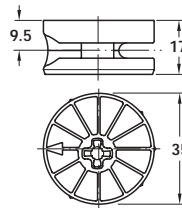

**A Maxifix housings**

Finish	SW 6	PZ 3
Bright	262.86.003	262.86.013
Nickel plated	262.86.703	262.86.713

Packing: 1 pc



- **B Maxifix cover caps**
- Plastic

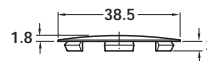

**B Maxifix cover caps**

Finish	Cat. No.
Brown	262.86.190
Black	262.86.390
White	262.86.790

Packing: 1 pc



- **C Maxifix connecting bolts**
- With M6 or M8 thread
- Screws into sleeve **D**
- Zinc plated steel

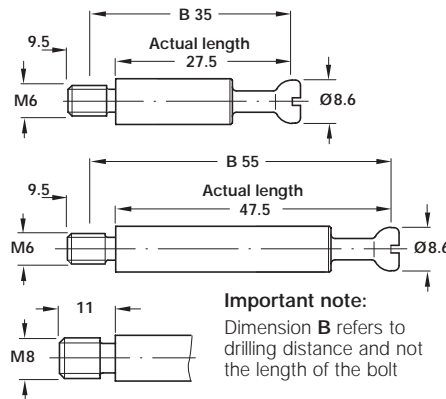

**Important note:**  
Dimension **B** refers to drilling distance and not the length of the bolt

**C Maxifix connecting bolts**

Drilling distance B	35 mm	55 mm
<b>M6</b> thread	262.86.901	262.86.902
<b>M8</b> thread	262.86.911	262.86.912

Packing: 1 pc



- **D Screw in sleeves**
- Hexagon socket and flange
- Zinc plated steel

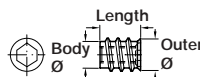

**D Screw in sleeves**

Internal thread	M6	M6	M8
Length	15	17	17
Outer Ø	12	12	14
Body Ø	7.5	7.5	9.5
Socket head size SW	6	6	8
Cat. No.	030.10.864	030.10.865	030.10.885

Packing: 1 pc



- **E Maxifix double-ended connecting bolts**
- For double-sided installation through Ø 10 mm holes
- Zinc plated steel

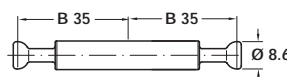

**E Maxifix double-ended connecting bolts**

Drilling distance B	35 mm
Cat. No.	262.86.921

Packing: 1 pc