

Plug In Shelf Supports for Ø 5 mm Holes

HÄFELE

Order Online at www.hafele.co.uk

Dimensions in mm

*Load carrying capacity applies to 4 shelf supports bearing an evenly distributed load
Testing was carried out according to DIN EN 1727
"Mechanical safety requirements for shelf supports"

Discontinued ●

Discontinued when stock = 0 +

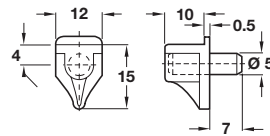

- **C** Shelf supports, plug in
- With galvanized steel pin
- For Ø 5 mm hole
- Load carrying capacity 60 kg*
- Plastic

C Shelf supports, plug in

Finish	Cat. No.
Brown	● 282.12.105
Transparent	+ 282.12.405

Packing: 1000 pcs

Discontinued/Disc. when stock = 0
For 282.12.105 offer alt. no. 282.27.107
For 282.12.405 offer alt. no. 282.27.401

Shelf Supports

2

Item D.
Added back on to page

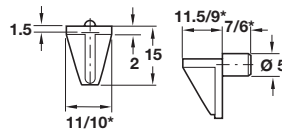

- **D** Shelf support, plug in
- With grooved plug
- For Ø 5 mm hole
- Load carrying capacity 100 kg*
- Plastic

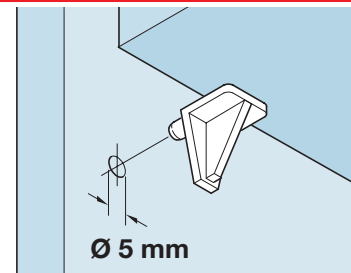

D Shelf support, plug in

Finish	Cat. No.
White	283.63.715

Packing: 500 pcs

Re-instated