

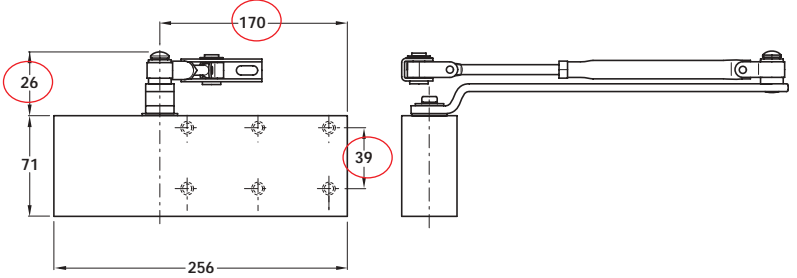

Item A.
Catalogue shows 44 mm, 133 mm and 43 mm
Correct dimensions are
26 mm, 170 mm and 39 mm



- A Overhead door closer, dual size 3-4**
- Surface door closer
- With backcheck
- Power size 3 and 4
- Door weights 40 kg - 80 kg
- Conforms to BS EN 1154. 1996
- Successful UK fire test to BS476
- Universal fixing
- Stainless steel armset-solid
- Includes full satin stainless steel cover

A Overhead door closer, dual size 3-4

Finish	Cat. No.
Satin stainless steel	931.83.610

Packing: 1 pc

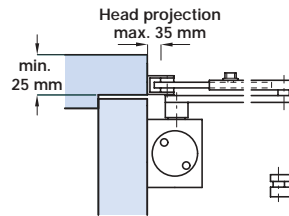

Standard application 1
Closer is fixed to the pull side of the door

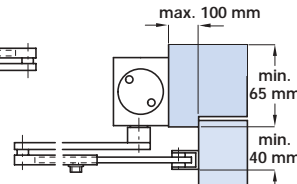

Transom application 61
Closer is fixed to the push side of the door (overhead installation)

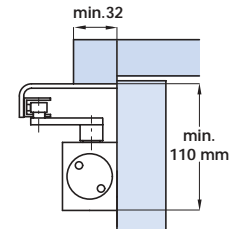

Parallel arm application 66
Closer is fixed to the push side of the door using fixing bracket

B Overhead door closers

Specification: TS1500

Universal surface mounted rack and pinion door closer with flat form arm for doors up to 1100 mm, with valve adjustable hydraulic latch action and closing speed

Fig. 1, Fig. 61 and Fig. 66 Applications

Certifire approved, CF144

Standard features:

Universal fixings (Fig.1, 61 and 66) in one closer

Power 3/4 shoe position for fig.1 and 61 only

TEXT ADDED

- Valve adjustable latching action
- Steel flat form arm
- Valve adjustable closing speed
- Hold open (specify)

Material:

Cast aluminium body

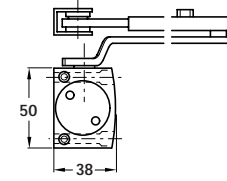
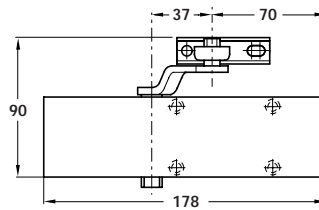

BOX ADDED

Conforms to BS EN 1154

Size	Max. door width	Min. closing moments
3/4	950 mm/1100mm	18 Nm

B Overhead door closers

Finish	Cat. No.
Silver	940.01.626
Gold	940.01.628

Packing: 1 pc



C Overhead door closers

Specification: TS2000

Universal surface mounted rack and pinion door closer with flat form arm for doors up to 1250 mm, with variable closing force, latch action and closing speed. Closing speed on the front of the adjustment on the front of the mechanism with the latch action determined by the closer arm, and the power by the position on the door.

Fig. 1, Fig. 61 and Fig. 66 Applications

Certifire approved. CF250

Standard features:

Universal fixings (Fig.1, 61 and 66) in one closer

One closer for three sizes

Variable closing force

Back-check (specify)

Adjustable latching action

Steel flat form arm

Adjustable closing speed on front of closer

Material:

Cast aluminium body

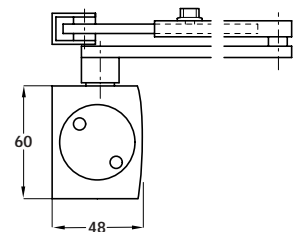
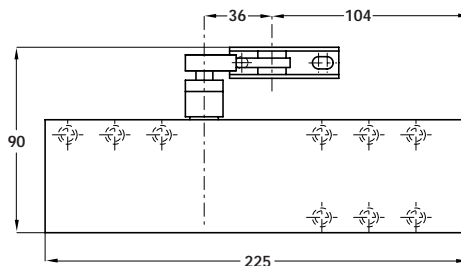

C Overhead door closers

Finish	Cat. No.
Silver	940.13.706
Gold	940.13.705

Packing: 1 pc

12.01.06/2*