

Dimensions in mm

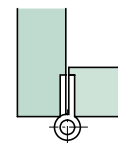
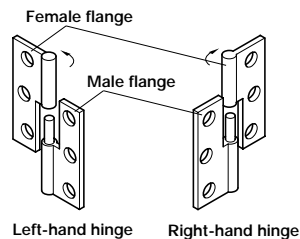
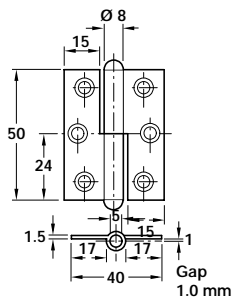

- **Straight hinges**
- For butting, inset or overlay doors
- For door thickness and side panel thickness as required

**Rolled steel furniture hinge, straight. Barrel length 50 mm**

Finish	Left	Right
Brass-plated	331.08.511	331.08.502

Packing: 10 pcs

3

Furniture Hinges

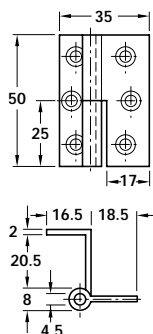

- **Drawn profiled brass hinge, cranked**
- For butting, overlay doors
- For door thickness 20-21 mm, side panel thickness as required



**Drawn profiled brass hinge, cranked**

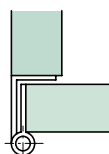

**Re-instated**

Finish	Left	Right
Polished	307.01.832	307.01.823
Matt nickel-plated	307.01.636	307.01.627

Packing: 10 pcs

11.07.06/10

We reserve the right to alter specifications without notice.