

Regula Hinges with 6 mm Exposed Axle

HÄFELE

Order Online at www.hafele.co.uk

Dimensions in mm



The hinge requirement is determined by the weight and the shape of the door

The table right gives you a guideline for 19 mm chipboard

Doors must not be wider than they are high

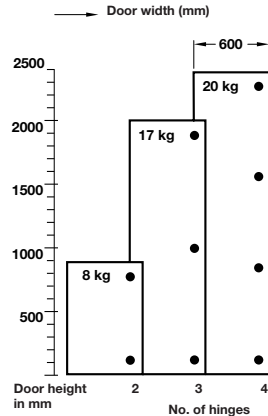

With Hospa Ø 3.5 mm raised head screws or press-fit version

Opening angle **250°**



With Hospa Ø 3.5 mm pan head screws

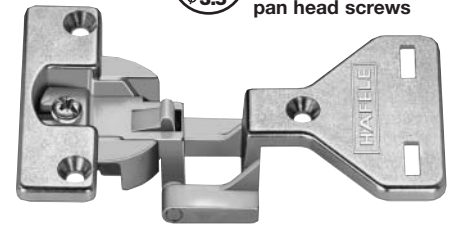

With pre-mounted expanding dowels and Hospa Ø 3.5 mm pan head screws



With pre-mounted Varianta Ø 5 mm screws



3

Regula hinges

- For door thickness 16 to 20 mm
- With lateral adjustment up to 3 mm
- With vertical adjustment ± 2 mm
- With spring
- Nickel-plated zinc alloy
- Opening angle 250°

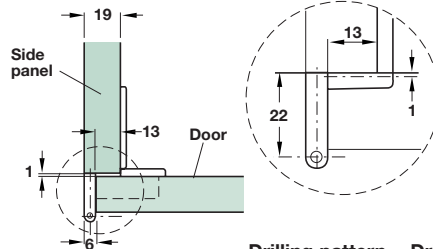

Drilling pattern for dowels or Varianta screws

Drilling pattern for Hospa screws

Discontinued

Discontinued when stock = 0

A Regula corner hinge with exposed axle

- Side panel mounting
- Door fixing: Hospa Ø 3.5 mm raised head countersunk screws
- Side panel fixing: Pre-mounted dowels and Hospa Ø 3.5 mm pan head screws, pre-mounted Varianta Ø 5 mm screws or Hospa Ø 3.5 mm pan head screws
- 13 mm door overlay

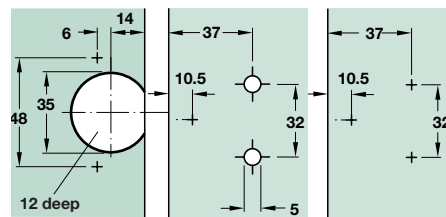

A Regula corner hinge with exposed axle

Side panel fixing	Cat. No.
Pre-mounted dowels and screws	344.21.020

Packing: 50 pcs

B Regula corner hinge with exposed axle

- Side panel mounting
- Door fixing: Press fit
- Side panel fixing: Pre-mounted dowels and Hospa Ø 3.5 mm pan head screws, pre-mounted Varianta Ø 5 mm screws or Hospa Ø 3.5 mm pan head screws
- 13 mm door overlay

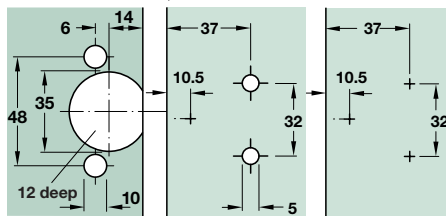

B Regula corner hinge with exposed axle

Side panel fixing	Cat. No.
Pre-mounted dowels and screws	344.21.120

Packing: pcs 50

C Regula corner hinge with exposed axle

- Side panel mounting
- Door fixing: press fit
- Side panel fixing: Pre-mounted dowels and Hospa Ø 3.5 mm pan head screws, pre-mounted Varianta Ø 5 mm screws or Hospa Ø 3.5 mm pan head screws
- 13 mm door overlay

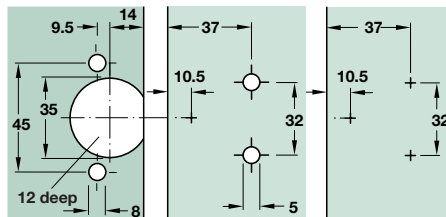

C Regula corner hinge with exposed axle

Side panel fixing	Cat. No.
Pre-mounted dowels and screws	344.21.220
Pre-mounted Varianta screws	344.21.210
Hospa screws	344.21.200

Packing: 50 pcs

D Regula corner hinge with exposed axle

- Side panel mounting
- Door fixing: Press fit
- Side panel fixing: Pre-mounted dowels and Hospa Ø 3.5 mm pan head screws, pre-mounted Varianta Ø 5 mm screws or Hospa Ø 3.5 mm pan head screws
- 13 mm door overlay

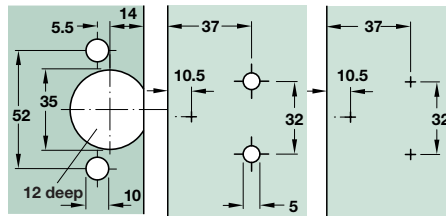

D Regula corner hinge with exposed axle

Side panel fixing	Cat. No.
Pre-mounted dowels and screws	344.21.320
Pre-mounted Varianta screws	344.21.310
Hospa screws	344.21.300

Packing: 50 pcs

Item E.
Added to page

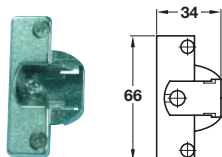

E Hinge cup arm

- For use with Regula corner hinge 344.21.300

Cat. No.	344.21.830
----------	------------

Order qty: 1 pc

Mounting screws

Hospa chipboard screws
Pan head Ø 3.5 mm with cross slots



Finish: Zinc-plated steel

Length	Cat. No.
15 mm	015.71.633
17 mm	015.71.642
20 mm	015.71.651

Packing: 1000 pcs

Mounting screws

Hospa chipboard screws raised head Ø 3.5 mm with cross slots



Finish: Nickel-plated steel

Length	Cat. No.
15 mm	015.55.639
17 mm	015.55.648
20 mm	015.55.657

Packing: 1000 pcs